



# Northumberland County Council

NORTH NORTHUMBERLAND LOCAL AREA COUNCIL  
23 August 2018

---

## REVIEW OF THE DEFINITIVE MAP AND STATEMENT OF PUBLIC RIGHTS OF WAY ALLEGED RESTRICTED BYWAYS NOS 5 & 6 PARISH OF HEPPLA

Report of the Executive Director of Local Services  
Cabinet Member: Councillor Glen Sanderson, Environment & Local Services

---

### **Purpose of report**

In this report, the Council is asked to give consideration to all the relevant evidence gathered in support and rebuttal of a proposal to add to the Definitive Map and Statement a restricted byway from the U4025 road east of Farnham Park in a general south-easterly direction to join the B6341 road west of Caistron.

### **Recommendation**

**It is recommended that the Council agrees that:**

- i) there is sufficient evidence to indicate that, on the balance of probabilities, public vehicular rights have been shown to exist over the route.**
- ii) the Natural Environment & Rural Communities Act, 2006 would appear to have extinguished the public's motorised vehicular rights over the route.**
- iii) the route be included in a future Definitive Map Modification Order as a restricted byway.**

### **1.0 BACKGROUND**

- 1.1** By virtue of Section 53 of the Wildlife and Countryside Act, 1981, the County Council is required to keep the Definitive Map and Statement under continuous review and make modification orders upon the discovery of evidence, which shows that the map and statement need to be modified.

- 1.2 The relevant statutory provisions which apply to upgrading a public right of way on the Definitive Map and Statement based on historical documentary evidence is Section 53(3)(c)(ii) of the Wildlife and Countryside Act, 1981, which requires the County Council (as Surveying Authority) to modify the Definitive Map and Statement following:

“the discovery by the authority of evidence which (when considered with all other relevant evidence available to them) shows:

“that a highway shown in the map and statement as a highway of a particular description ought to be there shown as a highway of a different description;”

- 1.3 All the relevant statutory provisions and competing rights and interests have been considered in making this report. The recommendation is in accordance with the law and proportionate, having regard to individuals' rights and the public interest.

## 2.0 PUBLIC EVIDENCE

- 2.1 In March 2017, Anne Lowrie of Longframlington submitted an application to upgrade to restricted byway, Parish of Hepple Public Footpaths Nos 5 & 6 from a point marked S on the U4025 road east of Farnham Park in a general south-easterly direction passing through Wreighill farm steading, then continuing in a general south-easterly direction to a point marked T on the B6341 road west of Caistron.
- 2.2 The application is supported by historical evidence including Greenwood's Map of 1828, the Wreighill and Caistron Tithe Awards of 1845 and 1846, the 1st Edition 6" & 25" O.S. extracts and accompanying Book of Reference, the 2nd Edition 6" O.S. map of 1899 and the Finance Act Plan of 1910 with the accompanying Book of Reference.
- 2.3 The application was also accompanied by the following submission:

### **The Road to Farnham**

- “1. The application route runs in a north westerly direction from grid ref. NT994015 (A) on the B6341 between Flotterton to Hepple to a point on the road C172 close to Low Farnham Farm, grid ref. NT973022 (D)..
- “2. It follows FP 120/006 from (A) to Wreighill Farm (C) where it continues to the road (D) as FP 120/004.
- “3. This alleged route is mainly a grass track with a stone base. But in parts it becomes a stone track. It runs along the edge of pasture and arable land. It is approximately 4m wide.
- “4. At point (B) it is joined from the south by an unsurfaced unclassified road, the U4057. This road is part of a promoted cycle route, The Sandstone Way.

"5. The application route is in the Parish of Hepple and can be seen on the OS Explorer OL16.

*See photographs of condition*

## **Documentary evidence**

### **1. 1828 Greenwood's County Map**

The alleged route is clearly shown connecting Caistron to Wreigh Hill (Wreighill) and Low Fernham (Farnham). It is shown largely unfenced as it is today. In the key it is shown as a 'cross road', a minor road joining two roads of greater importance..

*See appendix 1*

### **2. 1845 Tithe Award for for the township of Wreighill**

**DT 521 M**

"The alleged route is shown on the plan as passing through this township as an unfenced road. At its south east end, where it enters this township, it is labelled '*to Caistron*'. At its north west end, where it passes into the next township, it is labelled '*from Holystone*'. This suggests that it was a recognised public route of some length passing through three townships linking Caistron to Holystone.

"In addition the UCR to Hepple, which joins the alleged route at (B), is labelled '*to Hepple*'. In other words, this suggests the alleged route and this UCR were part of the minor road network at that time.

### **3. 1846 Tithe Award for the township of Caistron**

**DT 84 M**

"The current B6341, from which the application starts at (A), is labelled in one direction '*to Flotterton*' and in the other direction '*from Hepple*'.

"The alleged route travels through plot 3 from (A). It is labelled '*from Wreighill*' as it passes out of this township showing that it is a through route.

"In the apportionment, under the heading of North Caistron Estate, plot No. 3 is described as '*West Bank unenclosed road included*'.

*See appendix 2 & 3*

### **4. 1866 OS 1<sup>st</sup> ed scale 1:10,560, the 6 inch**

**Roll 9**

"The route is shown to pass through the townships of Wreighill and Caistron in the parish of Rothbury. It is shown clearly as an unfenced route, as it is today.

*See Appendix 4*

### **5. 1866 OS 1<sup>st</sup> ed. 25" scale 1:2,500**

**Sheets XLIII/8 & XLIV/9**

"Sheet XLIII/8 can be seen at Woodhorn but sheet XLIV/9 is missing. However most of the route, but not all, can be seen on the website [www.old-maps.co.uk](http://www.old-maps.co.uk) On the section shown, the route passes through fields with the following plot numbers. In Caistron township plots 4 & 3. In Wreighill township plots first one missing, then 15, 14 & 10.

"In the OS Book of Reference for Rothbury Parish, Caistron Township plots 3 & 4 are described as '*arable &c*'. In Wreighill Township plots 15, 14 & 10 are all described as '*pasture &c*'. This appears to be the normal format when an unfenced minor road passes through fields.

*See appendix 5 for maps & extracts from Book of Reference*

#### **6. 1899 2<sup>nd</sup> edition, scale 1:10,560, the 6 inch sheets XLIV SW, XLIII NE & SE**

"The application route is shown clearly on these sheets. It is not labelled as either FP or BR, which suggests it was recognised as a road rather than just a path at that time.

*See appendix 6*

#### **7. 1910 Finance Act Plan**

**NRO436/XLIV/9**

"On this plan the alleged route has been labelled in hand writing in red '*Public Bye Road*'. This is unusual and suggests that the agent for this estate wanted to make it clear that this was a public road and therefore not part of the productive land which was liable for development tax. It is shown to be in Plot 8 - Caistron Farm.

"The U4057 from Hepple is also labelled '*Public Bye Road*'. This has been written in the same handwriting as the above..

#### **1910 Finance Act Book of Reference**

**NRO2000/41**

"Plot 8 is described as being '*Caistron North*', the owners as '*Exors of late J Darglish*'. A deduction for '*public rights of way or user*' of £15 has been claimed. This indicates that the executors were aware of a public right of way crossing the plot of land.

*See appendix 7*

#### **Conclusion**

The evidence above suggests that there was a through route with public rights in the past. Please can you investigate if this route should be recorded on the definitive map as a restricted byway instead of a public footpath?"

### **3. LANDOWNER EVIDENCE**

- 3.1 A consultation was undertaken with the landowners in April 2017 but to date no response has been received.

## 4. CONSULTATIONS

- 4.1 In April 2017, the County Council carried out a consultation with the Parish Council, known owners and occupiers of the land and the local representatives of the “prescribed and local organisations” listed in the Council’s “Code of Practice on Consultation for Public Path Orders”.
- 4.2 By letter in May 2017 the County Access & Bridleways Officer for the British Horse Society responded to the consultation with the following comments:
- i) “This is an example of a useful ‘old road’ that has fallen into disuse although its existence is well documented as a through route in both the nineteenth and twentieth centuries. Part of it links up with the north end of an unclassified county road from Hepple which, for no good reason, suddenly becomes a public footpath on the definitive map at the moment.
  - ii) “If this route is added to the Definitive Map another anomaly will have been removed. This would mean that cyclists’ use of the northern part of the alleged route as a section of the Sandstone Way would become legal rather than depending on permission, which can be withdrawn at any time.”

## 5. DOCUMENTARY EVIDENCE

- 5.1 A search has been made, relating to historical evidence and the following copies are enclosed for consideration.

1769 Armstrong’s County Map

There is evidence of a track from Caistron (Casterlon) to Farnham (Fairnham) passing through Wreigh which approximates the claimed route.

1820 Fryer’s County Map

There is evidence of a track over the western and middle section of the route but no south-easterly link to Caistron.

1828 Greenwood’s County Map

There is evidence of a track approximating the entire length of the claimed route.

1820-32 Cary’s Map

There is evidence of a track over the western and middle section of the route but no south-easterly link to Caistron.

- 1845 Wreighill Tithe Award (Applicant's Plan)
- There is evidence of a track over the western section of the route and the track is labelled 'from Wreighill'.
- 1846 Caistron Tithe Award (Applicant's Plan)
- There is evidence of a track over the eastern section of the route which is labelled 'from Wreighill'.
- 1866 1<sup>st</sup> Edition O.S. Map: Scale 1:2,500 & Book of Reference (Applicant's Plan)
- There is evidence of a track over the entire length of the claimed route.
- This section of the claimed route within Caistron township is annotated in the Book of Reference with the numbers 3 and 4 and is identified as 'Arable &c'.
- This section of the claimed route within Wreighill township is annotated in the Book of Reference with the number 10, 14 & 15 and is identified as 'pasture &c'.
- 1866 1<sup>st</sup> Edition O.S. Map: Scale 1:10,560
- There is evidence of a track over the entire length of the claimed route.
- 1899 2<sup>nd</sup> Edition O.S. Map: Scale 1:10,560
- There is evidence of a track over the entire length of the claimed route.
- 1925/6 3<sup>rd</sup> Edition O.S. Map: Scale 1:10,560
- There is evidence of a track over the entire length of the claimed route.
- 1979 Provisional Edition O.S. Map: Scale 1:10,560
- There is evidence of a track over the entire length of the claimed route.
- 2006 The Council's 'List of Streets' (2 May 2006)
- A publicly maintainable highway is not identified over any part of the claimed route.

## **6. SITE INVESTIGATION**

- 6.1 From the U4025 road east of Farnham Park the path follows the access track to Wreighill as a stone / gravel surfaced road in a south-easterly and easterly direction crossing a cattle grid then southerly through the farm steading to cross another cattle grid. The path then continues as a well defined stone / gravel track across open pasture, over another cattle grid, then continuing to a gate at the southern boundary of a plantation. The path continues in a south-easterly and easterly direction as a grass/stone surfaced track but is still well defined, through another gate, then continuing to a small gated enclosure to the north of Dog's Leg Plantation. The path then swings in a south-easterly direction through a pasture field then easterly following the field boundary to join the the B6341 road west of Caistron.

## **7. DISCUSSION**

- 7.1 Section 53(3)(c)(ii) of the Wildlife and Countryside Act 1981, requires the County Council to modify the Definitive Map when evidence is discovered which, when considered with all other relevant evidence available to them shows:

that a highway shown in the map and statement as a highway of a particular description ought to be there shown as a highway of a different description;

- 7.2 When considering an application or proposal for a modification order, Section 32 of the Highways Act, 1980 provides for "any map, plan or history of the locality or other relevant document" to be tendered in evidence and such weight to be given to it as considered justified by the circumstances, including the antiquity of the tendered document, the status of the person by whom and the purpose for which it was made or compiled, and the custody in which it has been kept and from which it is produced.
- 7.3 The representation of a path or track on an Ordnance Survey map is not conclusive evidence that it is a public right of way. It is only indicative of its physical existence at the time of the survey.
- 7.4 The Natural Environment and Rural Communities Act 2006 (NERC Act 2006) had a major impact upon the recording of byways open to all traffic based upon historical documentary evidence. Under section 67 of the Act, any existing, but unrecorded, public rights of way for mechanically propelled vehicles were extinguished unless one of the 'saving' provisions applied. In brief, these saving provisions were: (a) if the main lawful public use between 2001 and 2006 was with motor vehicles; (b) if the route was on the List of Streets (on 2 May 2006) and not also on the Definitive Map as something less than a byway open to all traffic; (c) the route was legally created expressly for motor vehicular use; (d) the route was a road deliberately constructed for public motor vehicular use; or (e) the vehicular highway came about as a result of unchallenged motor vehicular use before December 1930. None of the above saving provisions apply therefore, if the track were to be recorded as a

restricted byway, it would be an offence for any member of the public to use the route with a mechanically propelled vehicle without the landowner's permission.

- 7.5 The County Maps of Fryer and Cary appear to depict a track over the western part of the claimed route while Greenwood's County Map depicts a track over the entire length of the claimed route. If the purpose of the maps was to depict commercial travel routes throughout the County then it is reasonable to assume that the route carried higher rights than public footpath.
- 7.6 All of the Ordnance Survey plans from the 1<sup>st</sup> Edition map c1866 to the plan in 1979 depict a track over the entire length of the claimed route. It is acknowledged that as the route has been recorded on the Definitive Map and Statement since the 1950s as a public footpath, it is expected that the route would be identified on the later edition plans.
- 7.7 In the Valuation Books accompanying the plans for the 1910 Finance Act it is noted that there is a deduction of £15 for 'right of way or user'. What is interesting is that the valuers have also identified the eastern section of the route as a 'Public Bye Road' suggesting that, in their opinion, the route was more than just a public bridleway.
- 7.8 The Wreighill and Castron Tithe Awards combined would suggest that there was a track over the entire length of the claimed route annotated with labels at either end to indicate that the road to Wreighill was a through route and open to the public. While the tithe award gives no clear indication as to the status of the route, the wording in the accompanying apportionment would suggest that it is more than pedestrian.
- 7.9 The 1<sup>st</sup> Edition Ordnance Survey 'Book of Reference' plan does not depict the route as a 'Public Road' as the track is included within larger land parcels.
- 7.10 In the light of the evidence submitted it appears that the historical evidence is sufficient to demonstrate that a public vehicular right of way has on the balance of probabilities been proven to exist over the route.
- 7.11 Advice from the Planning Inspectorate in their 'consistency guidelines' states that it is important to have the correct width, where known, recorded in the definitive statement. It is proposed to record a width to reflect the current physical characteristics of the route, therefore a minimum width of 5 metres would be included in any future modification order.

## **8. CONCLUSION**

- 8.1 In the light of the evidence submitted it appears that on the balance of probabilities, public vehicular rights exist over the route.
- 8.2 The route be included in a future Definitive Map Modification order as a restricted byway.



## **BACKGROUND PAPERS**

Local Services Group File A/20/5 & 6z

Report Author      John McErlane – Definitive Map Officer  
                              (01670) 624136  
                              [John.McErlane@northumberland.gov.uk](mailto:John.McErlane@northumberland.gov.uk)



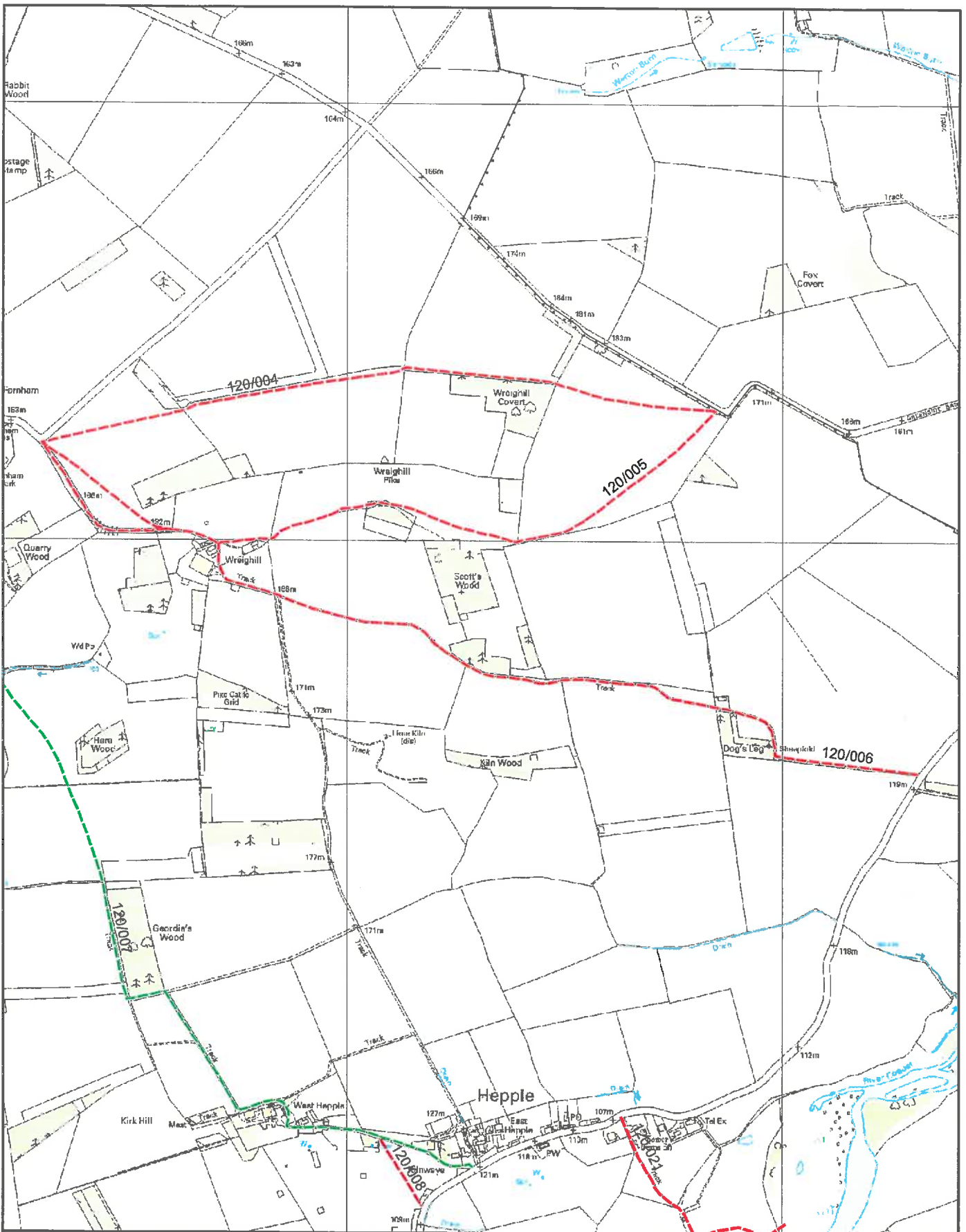

  
**Northumberland**  
 County Council

Contact: John McErlane  
 Tel: 01670 624136  
 Email: John.McErlane@northumberland.gov.uk

**Legend**

- Footpath
- Bridleway
- - - Restricted Byway
- Byway Open to All Traffic

This is a computer generated extract of the Working Copy of the Definitive Map of Public Rights of Way

Scale: 1:12,000

This map is reproduced from Ordnance Survey material with the permission of Ordnance Survey on behalf of the Controller of Her Majesty's Stationary Office Crown Copyright. Unauthorised reproduction infringes Crown Copyright and may lead to prosecution or civil proceedings. License no. 100049048 (2012).

PUBLIC RIGHTS OF WAY

WILDLIFE AND COUNTRYSIDE ACT 1981, PART III  
DEFINITIVE MAP AND STATEMENT FOR THE COUNTY OF NORTHUMBERLAND

CERTIFICATE OF SERVICE OF NOTICE OF  
APPLICATION FOR MODIFICATION ORDER

Former Borough/District ..... ALNWICK .....

Parish ..... HEPALE .....

To: Asset & Infrastructure Manager  
Local Services Group  
Northumberland County Council  
County Hall  
Morpeth  
NE61 2EF

I/We ..... ANNE LOWRIE ..... (Name)

of THE OLD VICARAGE, LONGFRAMLINGTON, ..... (Address)  
MORPETH, NE65 8AQ .....

hereby certify that the requirements of Paragraph 2 of Schedule 14 to the Wildlife and Countryside Act 1981 have been complied with, and each of the following landowners and occupiers affected by the claim have been notified.

Name	Address
<u>Fr J. Walton</u> .....	<u>Flotterton Hall, Flotterton,</u> .....
.....	<u>Morpeth, NE65 7LF</u> .....
<u>Mr &amp; Mrs C Watmore</u> .....	<u>Holystone Estate, Farubain Park,</u> .....
.....	<u>Sharpeston, Morpeth, NE65 7AQ</u> .....
.....	.....
.....	.....
.....	.....

Dated 9/3/17 .....

Signed  .....

PUBLIC RIGHTS OF WAY

WILDLIFE AND COUNTRYSIDE ACT 1981, PART III  
DEFINITIVE MAP AND STATEMENT FOR THE COUNTY OF NORTHUMBERLAND

APPLICATION FOR MODIFICATION ORDER

Former Borough/District ALNWICK

Parish HEPPLE Rights of Way No. 120/006

(on Definitive Map) 120/004

To: Asset & Infrastructure Manager  
Northumberland County Council  
County Hall  
Morpeth  
Northumberland  
NE61 2EF

I/we ANNE LOWRIE (Name)

of THE OLD VICARAGE, LONGFRANKLINGTON (Address)  
MORPETH, NE65 8AQ

hereby apply for an order, under Section 53 (2) of the Wildlife and Countryside Act 1981, modifying the Definitive Map and Statement for the County of Northumberland, by:-

1. Adding the (footpath) (bridleway) (restricted byway) (byway open to all traffic) (*Delete whichever is inapplicable*)

from .....

to .....

2. (Upgrading) (~~downgrading~~) to a (~~footpath~~) (~~bridleway~~) (restricted byway) (~~byway open to all traffic~~) the (footpath) (~~bridleway~~) (restricted byway) (~~byway open to all traffic~~) (*Delete whichever is inapplicable*)

from GR NT 994015 B6341

to GR NT 973022 C172

3. Deleting the (footpath) (bridleway) (restricted byway) (byway open to all traffic) (*Delete whichever is inapplicable*)

from .....

to .....

4. (Varying) (adding to) the particulars relating to the (footpath) (bridleway) (restricted byway) (byway open to all traffic) (*Delete whichever is inapplicable*)

from .....

to .....

by providing that .....  
as shown on the plan attached.

I/we attach copies of the following documentary evidence (including statements of witness) set out overleaf in support of this application.

Dated 9/3/17 Signed \_\_\_\_\_

NOTE: This application **must** be accompanied by a map showing the right(s) of way applied for. Legally such a map must be at a scale of not less than 2½" to 1 mile, but 6" to 1 mile (being the scale at which the Definitive Map is to be prepared and maintained) will normally be preferable.



## The Road to Farnham

### The application route

1. The application route runs in a north westerly direction from grid ref. NT994015 (A) on the B6341 between Flotterton to Hepple to a point on the road C172 close to Low Farnham Farm, grid ref. NT973022 (D).
2. It follows FP 120/006 from (A) to Wreighill Farm (C) where it continues to the road (D) as FP 120/004.
3. This alleged route is mainly a grass track with a stone base. But in parts it becomes a stone track. It runs along the edge of pasture and arable land. It is approximately 4m wide.
4. At point (B) it is joined from the south by an unsurfaced unclassified road, the U4057. This road is part of a promoted cycle route, The Sandstone Way.
5. The application route is in the Parish of Hepple and can be seen on OS Explorer OL16.

***See photographs of condition***



## Documentary evidence

### 1. 1828 Greenwood's County Map

The alleged route is clearly shown connecting Caistron to Wreigh Hill (Wreighill) and Low Fernham (Farnham). It is shown largely unfenced as it is today. In the key it is shown as a 'cross road', a minor road joining two roads of greater importance.

*See appendix 1*

### 2. 1845 Tithe Award for the township of Wreighill

DT 521 M

The alleged route is shown on the plan as passing through this township as an unfenced road. At its south east end, where it enters this township, it is labelled 'to Caistron'. At its north west end, where it passes into the next township, it is labelled 'from Holystone'. This suggests that it was a recognised public route of some length passing through three townships linking Caistron to Holystone.

In addition the UCR to Hepple, which joins the alleged route at (B), is labelled 'to Hepple'. In other words, this suggests the alleged route and this UCR were part of the local minor road network at that time.

### 3. 1846 Tithe Award for the township of Caistron

DT 84 M

The current B6341, from which the application route starts at (A), is labelled in one direction 'to Flotterton' and in the other direction 'from Hepple'.

The alleged route travels through plot 3 from (A). It is labelled 'from Wreighill' as it passes out of this township showing that it is a through route.

In the apportionment, under the heading of North Caistron Estate, plot No. 3 is described as 'West Bank unenclosed road included'.

*See appendix 2 & 3*

### 4. 1866 OS 1st ed scale 1:10,560, the 6 inch

Roll 9

The route is shown to pass through the townships of Wreighill and Caistron in the parish of Rothbury. It is shown clearly as an unfenced route, as it is today.

*See Appendix 4*

### 5. 1866 OS 1<sup>st</sup> ed. 25" scale 1:2,500

sheets XLIII/8 & XLIV/9

Sheet XLIII/8 can be seen at Woodhorn but sheet XLIV/9 is missing. However most of the route, but not all, can be seen on the website [www.old-maps.co.uk](http://www.old-maps.co.uk) On the section shown, the route passes through fields with the following plot numbers. In



Castron township plots 4 & 3. In Wreighill township plots first one missing, then 15, 14 & 10.

In the OS Book of Reference for Rothbury Parish, Castron Township plots 3 & 4 are described as 'arable &c'. In Wreighill Township plots 15, 14 & 10 are all described as 'pasture &c'. This appears to be the normal format when an unfenced minor road passes through fields.

*See appendix 5 for maps & extracts from Book of Reference*

**6. 1899 OS 2<sup>nd</sup> edition, scale 1:10,560, the 6 inch sheets XLIV SW, XLIII NE & SE**

The application route is shown clearly on these sheets. It is not labelled as either FP or BR, which suggests it was recognised as a road rather than just a path at that time.

*See appendix 6*

**7. 1910 Finance Act Plan**

**NRO436/XLIV/9**

On this plan the alleged route has been labelled in hand writing in red 'Public Bye Road'. This is unusual and suggests that the agent for this estate wanted to make it clear that this was a public road and therefore not part of the productive land which was liable for development tax. It is shown to be in Plot 8 – Castron Farm.

The U4057 from Hepple is also labelled 'Public Bye Road'. This has been written in the same handwriting as the above.

**1910 Finance Act Book of Reference**

**NRO2000/41**

Plot 8 is described as being 'Castron North', the owners as 'Exors of late J Daglish'. A deduction for 'public right of way or user' of £15 has been claimed. This indicates that the executors were aware of a public right of way crossing this plot of land.

*See appendix 7*

**Conclusion**

The evidence above suggests that there was a through route with public rights in the past. Please can you investigate if this route should be recorded on the definitive map as a restricted byway instead of a public footpath?

Sent to NCC March 2017

Application route showing reference points

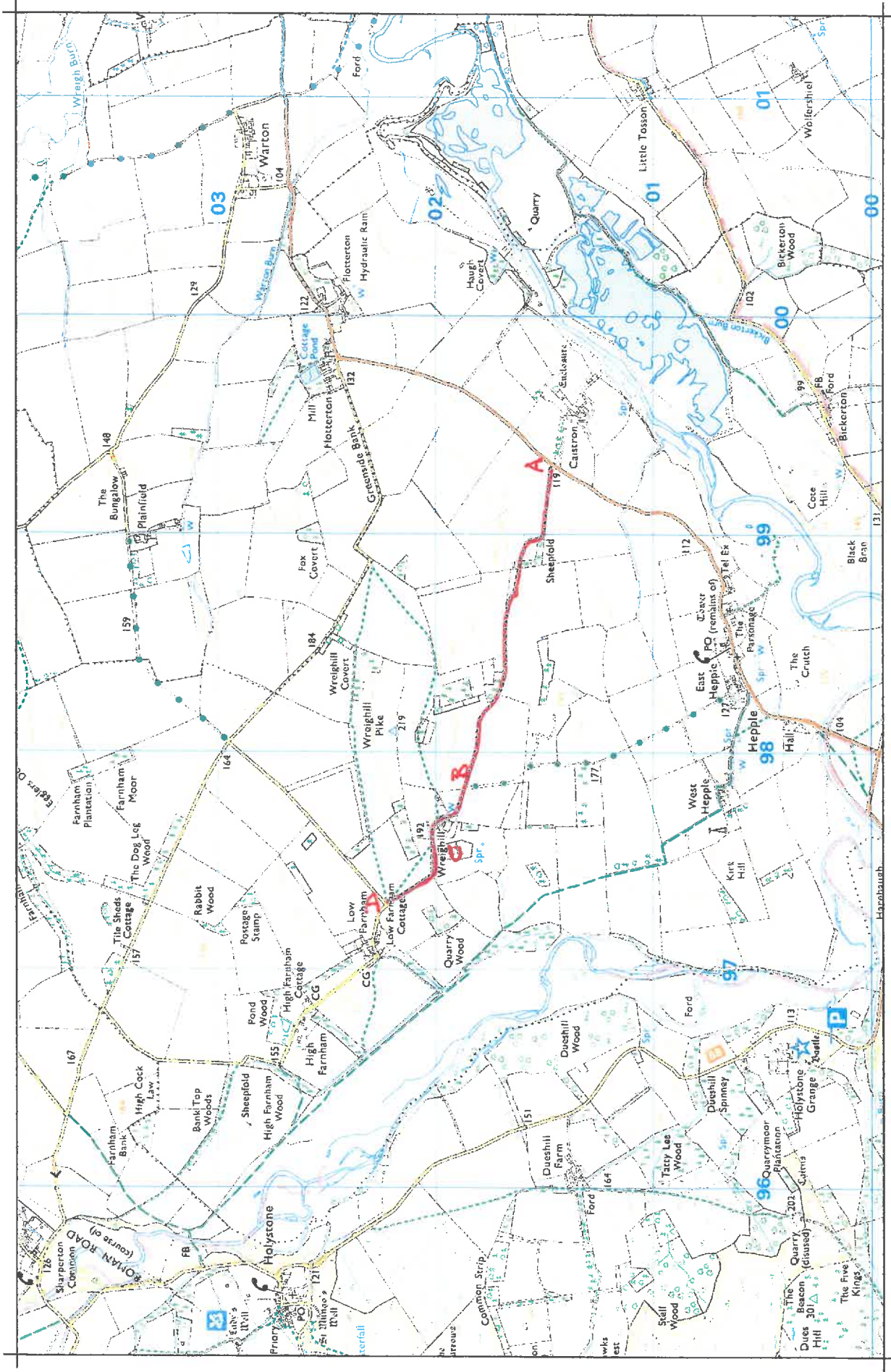

Map Scale 1:25,000

Mapping sourced from



This product includes mapping data licensed from Ordnance Survey under the terms and conditions of HMSO. © Crown copyright and/or database right 2006. All rights reserved. License number 300045815

Appendix 1

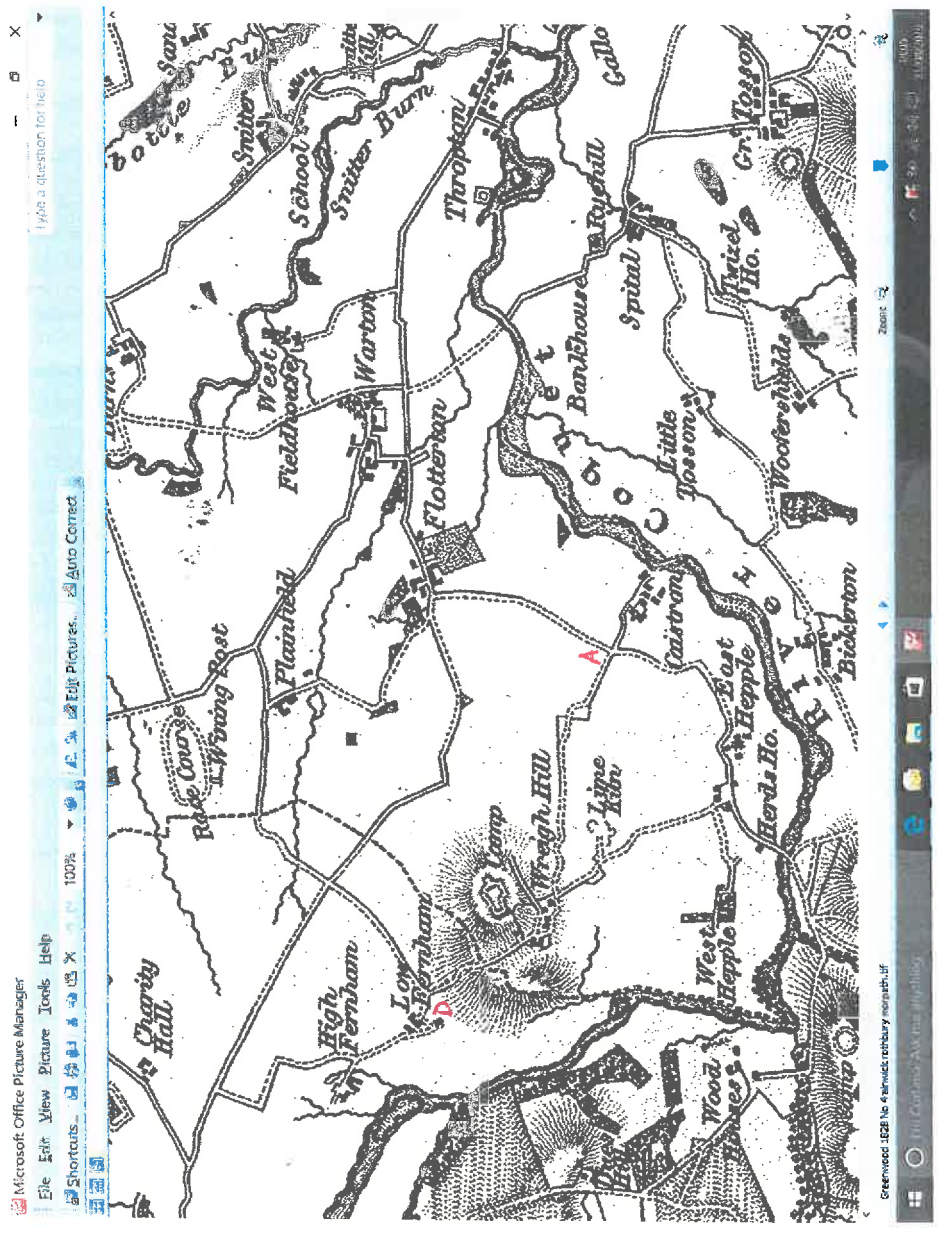

Extract from Greenwood map 1828 showing the route

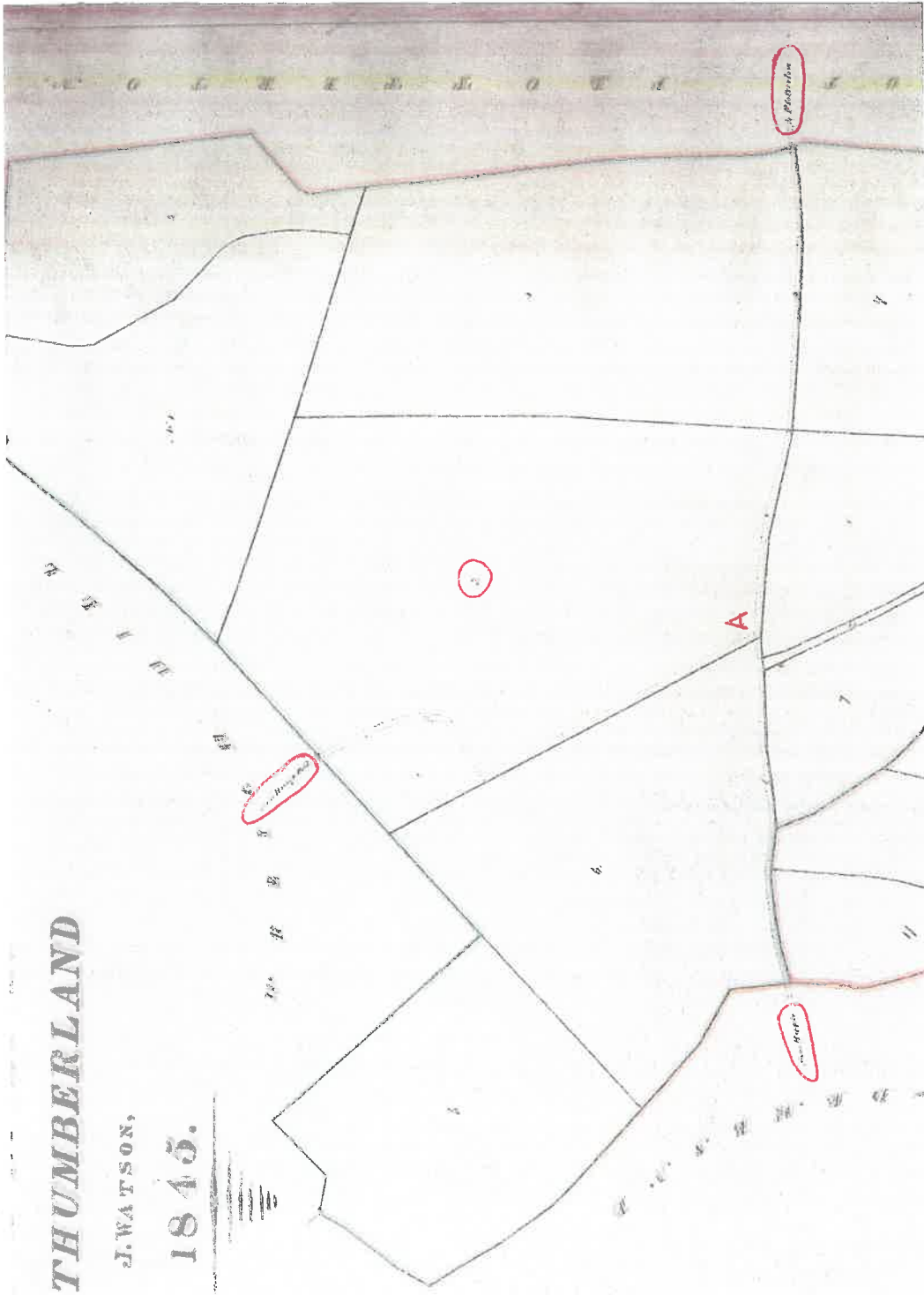

1846 Tithe Award for the township of Caistron

Appendix 3

OCCUPIERS.	Numbers referring to the Plan.	NAME AND DESCRIPTION of LANDS AND PREMISES.
<i>George Storey</i>		<i>North Causton Estate</i>
	1	<i>Hill Head field</i>
	2	<i>Mare</i>
	3	<i>West Bank uninclosed road included</i>
	4	<i>East Bank do do</i>
	5	<i>Thorn Tree field</i>
	6	<i>Midgey Hole uninclosed road included</i>
	7	<i>Bucke Close</i>
	8	<i>Ayle field or West Close</i>
	9	<i>Horse Close</i>
	10	<i>High Camp field</i>
	11	<i>Low Camp field</i>
	12	<i>Home Close and Haugh uninclosed road water &amp;c included</i>
	13	<i>East Garden</i>
	14	<i>West do</i>
	15	<i>School Garden</i>
16	<i>Perpetual Water Stake garden</i>	
<i>George Storey</i>		<i>South Causton Estate</i>
	17	<i>West Dodridge</i>
	18	<i>Middle Dodridge</i>
	19	<i>East Dodridge</i>
	20	<i>Haugh West of West do &amp; uninclosed roads included</i>

1846 Tithe Award for the township of Causton

Appendix 4

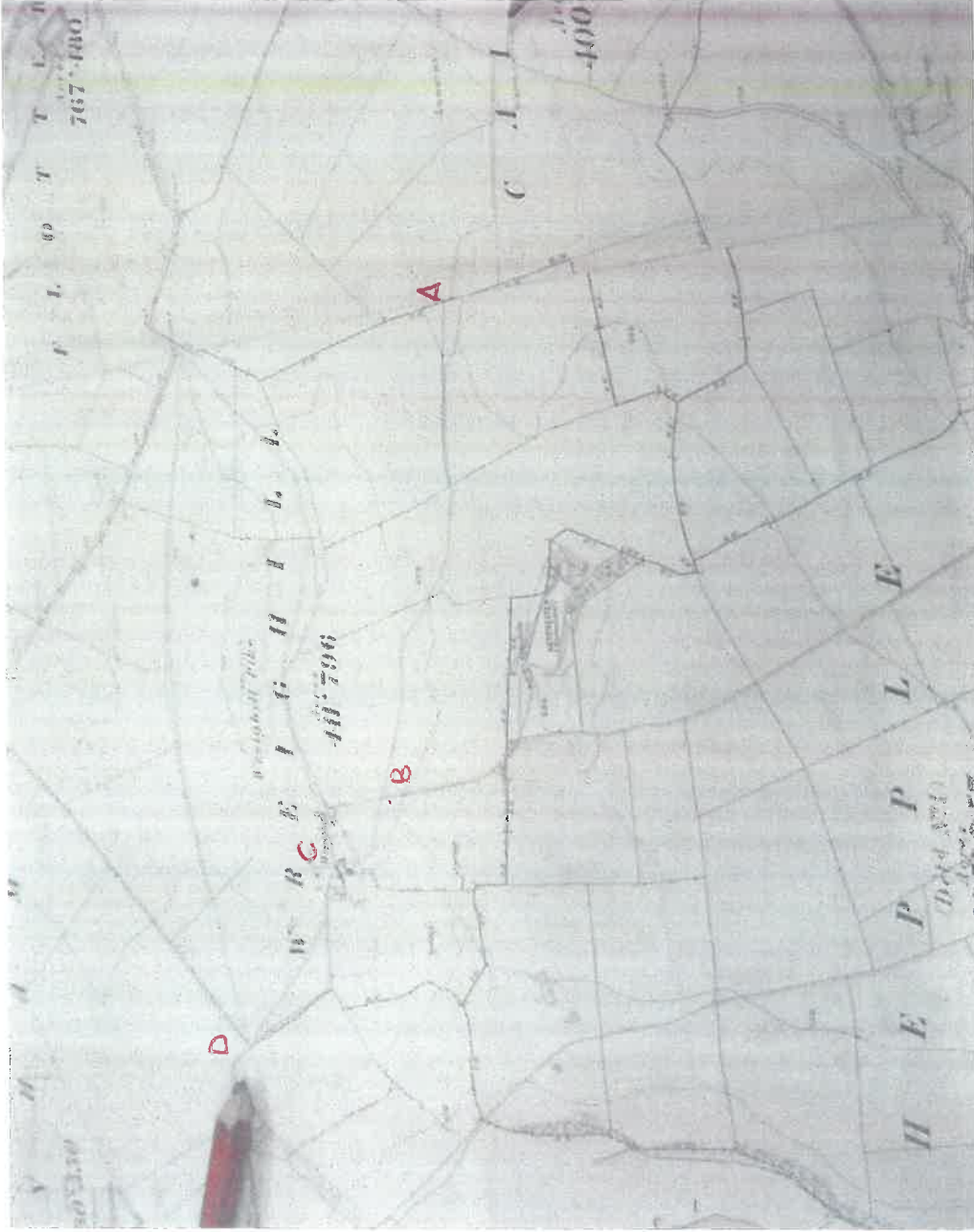

1866 OS 1st ed scale 1:10,560, the 6 inch

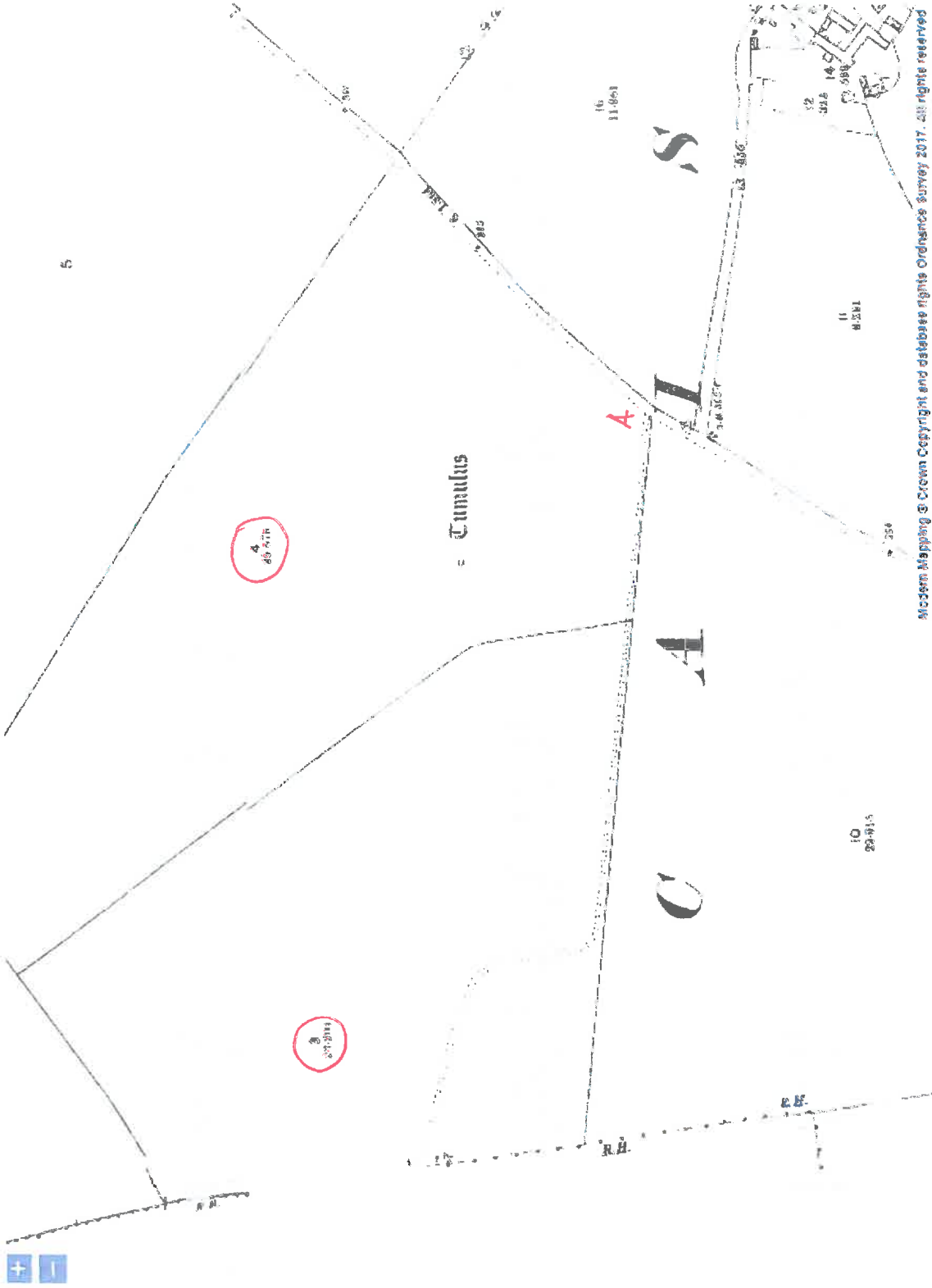

Remarks.	No. on Plan.	Area in Acres.	Remarks.	No. on Plan.	Area in Acres.	Remarks.
	<b>TOWNSHIP OF CAISTRON.</b>			<b>TOWNSHIP OF NEPPLE.</b>		
	1	13-896	Arable.	2	-141	River Coquet.
	2	23-656	Arable.	3	-168	Pasture.
	3	23-201	Arable, &c.	4	-468	Wood.
	4	25-878	Arable, &c.	5	1-562	Wood.
	5	35-189	Arable.	6	2-749	Pasture.
	6	1-384	Public road.	7	1-743	Pasture, &c.
	7	14-592	Arable.	8	-218	Houses, gardens, &c.
	8	12-096	Arable.	8a	1-493	Stream (Grassless Burn).
	9	20-723	Pasture.	9	2-928	Pasture.
	10	29-913	Pasture.	10	-082	Pasture.
	11	8-291	Pasture.	11	-496	Garden.
	12	-872	Pasture.	12	-458	Garden.
	13	-530	Public road.	13	-517	Garden.
	14	-599	Yards, &c.	14	-617	Arable.
	15	2-919	Houses, yards, gardens, &c. (Caistron).	15	1-047	Pasture, &c.
	16	11-961	Arable.	16	5-774	Wood.
	16a	-271	Garden.	17	2-115	Public road.
	17	8-037	Pasture.	18	23-408	Wood, &c.
	18	9-867	Arable.	19	-172	Wood.
	19	7-893	Arable.	20	4-345	Pasture, &c.
	20	10-821	Arable.	21	-168	Wood.
	21	11-704	Pasture.	22	-447	Garden.
	22	18-348	Pasture, &c.	23	-707	Wood.
	23	-903	Stream.	23a	-002	House (part of).
	24	10-223	Pasture, &c.	24	-080	Pasture.
	25	21-280	River Coquet.	25	-586	Rough pasture.
	26	31-151	Pasture, &c.	26	22-873	Wood.
	27	32-909	Pasture, &c.	27	1-884	Wood, &c.
	28	12-942	Arable.	28	-537	Pasture.
		400-635		29	1-594	Wood.
				30	-539	Garden, &c.
				31	-756	Wood.
				32	15-924	Arable.
				33	2-390	Wood.
				34	4-266	Wood.
				35	118-824	Rough pasture.
				36	9-559	Wood, &c.
				37	-391	Wood.
				38	4-721	Rough pasture, &c.
				39	3-820	Wood.
				40	4-625	Wood, &c.
				41	1-224	Wood, &c.
				42	-426	Wood.
				43	-531	Wood.
				44	-415	Wood.
				45	-438	Wood.
					247-594	Carried forward.
	<b>RECAPITULATION.</b>					
		376-518	Land.			
		1-934	Public roads.			
		22-183	Water.			
		400-635	Total area of the Township of Caistron.			



Use of this map viewer is made available solely for non-commercial purposes



3

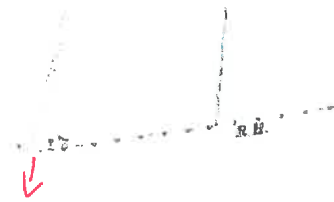

Modern Mapping © Crown Copyright and database rights Ordnance Survey 2017. All rights reserved. Mahatma © Copyright and database rights AIA Maps on 14/04/17. All rights reserved. Mahatma form.

1866 OS 1<sup>st</sup> ed. 25" scale 1:2,500

Use of this map viewer is made available solely for non-commercial purposes

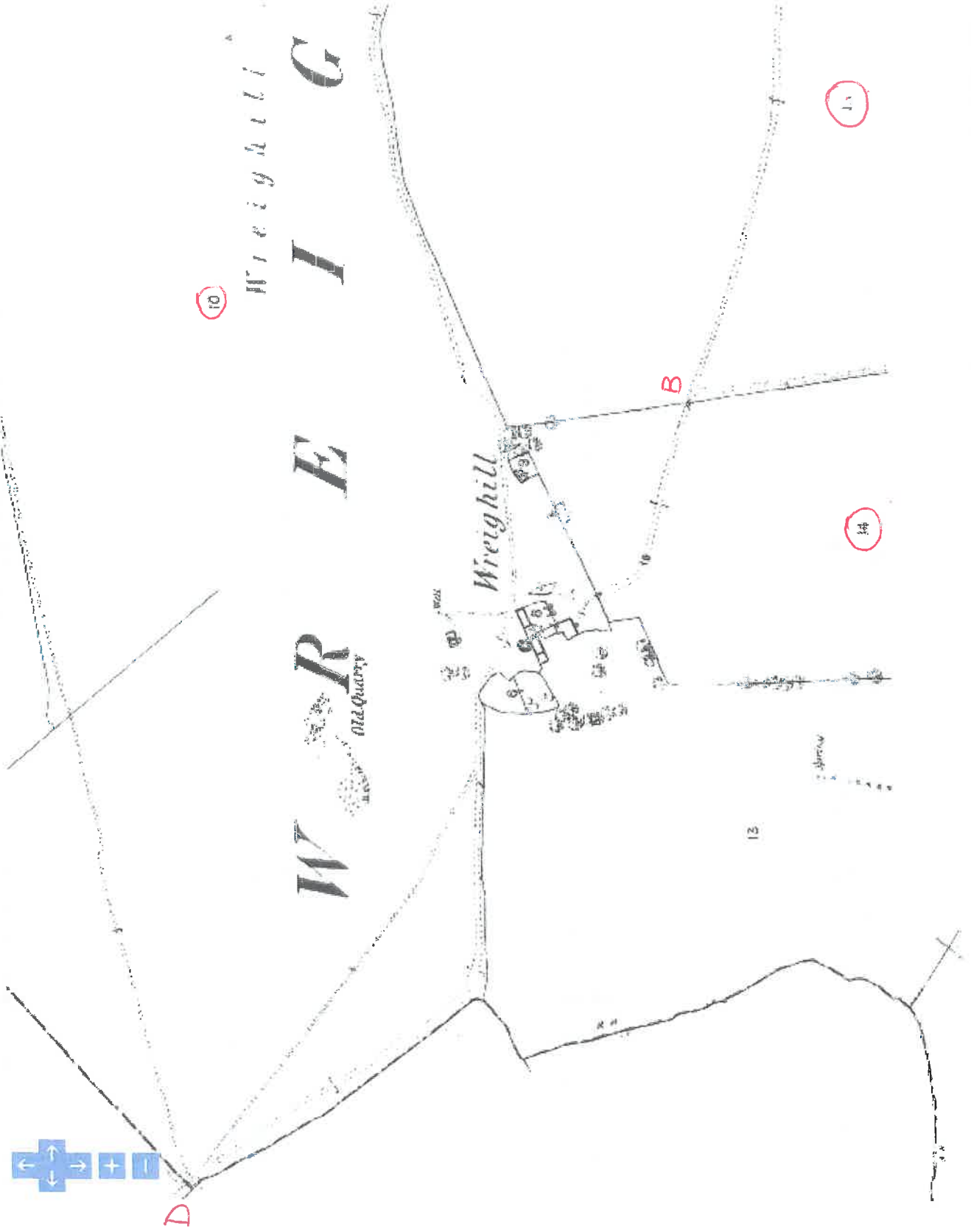

No. on Plan.	Area in Acres.	Remarks.	No. on Plan.	Area in Acres.	Remarks.
<b>TOWNSHIP OF DEBDON</b> (Detached).			<b>RECAPITULATION.</b>		
1	.216	House, garden, &c. (Whitefield House).	411.056	Land.	
2	5.540	Pasture, &c.	.740	Public road.	
3	33.097	Rough pasture.	411.796	Total area of the Township Wreighill.	
	38.853	Area of the Township of Debdon (De- tached).			
<b>RECAPITULATION FOR THE TOWNSHIP.</b>			<b>TOWNSHIP OF SNITTER.</b>		
	287.084	Land.	1	20.085	Rough pasture, &c.
	.882	Public road.	2	14.600	Pasture.
	287.966	Total area of the Township of Deb- don.	3	27.362	Pasture, &c.
			4	24.798	Pasture, &c.
			5	11.509	Pasture.
			6	.883	Houses, yards, garden, &c. (Silverside).
			7	5.397	Pasture.
			8	9.940	Pasture, &c.
			9	10.298	Pasture, &c.
			10	.544	Wood, &c.
			11	14.991	Pasture, &c.
			12	31.368	Pasture.
			13	7.008	Public road.
			14	12.234	Arable.
			15	13.947	Arable.
			16	10.846	Pasture.
			17	21.027	Pasture.
			18	20.710	Pasture, &c.
			18a	.181	Township road.
			19	.860	Houses, yards, garden, &c. (Snitter Barns).
			20	.152	Houses and yards.
			21	.086	Garden, &c.
			22	1.843	Township road.
			23	33.306	Arable.
			24	16.717	Arable.
			25	10.089	Pasture.
			26	14.273	Arable.
			27	16.400	Arable.
			28	15.919	Arable, &c.
			29	31.976	Pasture, &c.
			30	19.110	Arable.
			31	20.579	Arable.
			32	.566	Pasture.
			33	47.469	Pasture, &c.
			487.280	Carried forward.	
<b>TOWNSHIP OF WREIGHILL.</b>					
1	17.289	Pasture.			
2	.740	Public road.			
3	35.969	Pasture.			
4	22.432	Pasture.			
5	21.192	Pasture.			
6	.299	Gardens.			
7	.022	House, &c.			
8	.201	Houses, yards, } &c. } Wreighill.			
9	.072	Houses and gar- den.			
10	90.663	Pasture, &c.			
11	12.670	Pasture, &c.			
12	22.214	Pasture, &c.			
13	18.718	Pasture, &c.			
14	17.007	Pasture, &c.			
15	40.886	Pasture, &c.			
16	1.104	Pasture.			
17	47.185	Pasture, &c.			
18	35.155	Arable.			
19	28.028	Pasture, &c.			
	411.796				

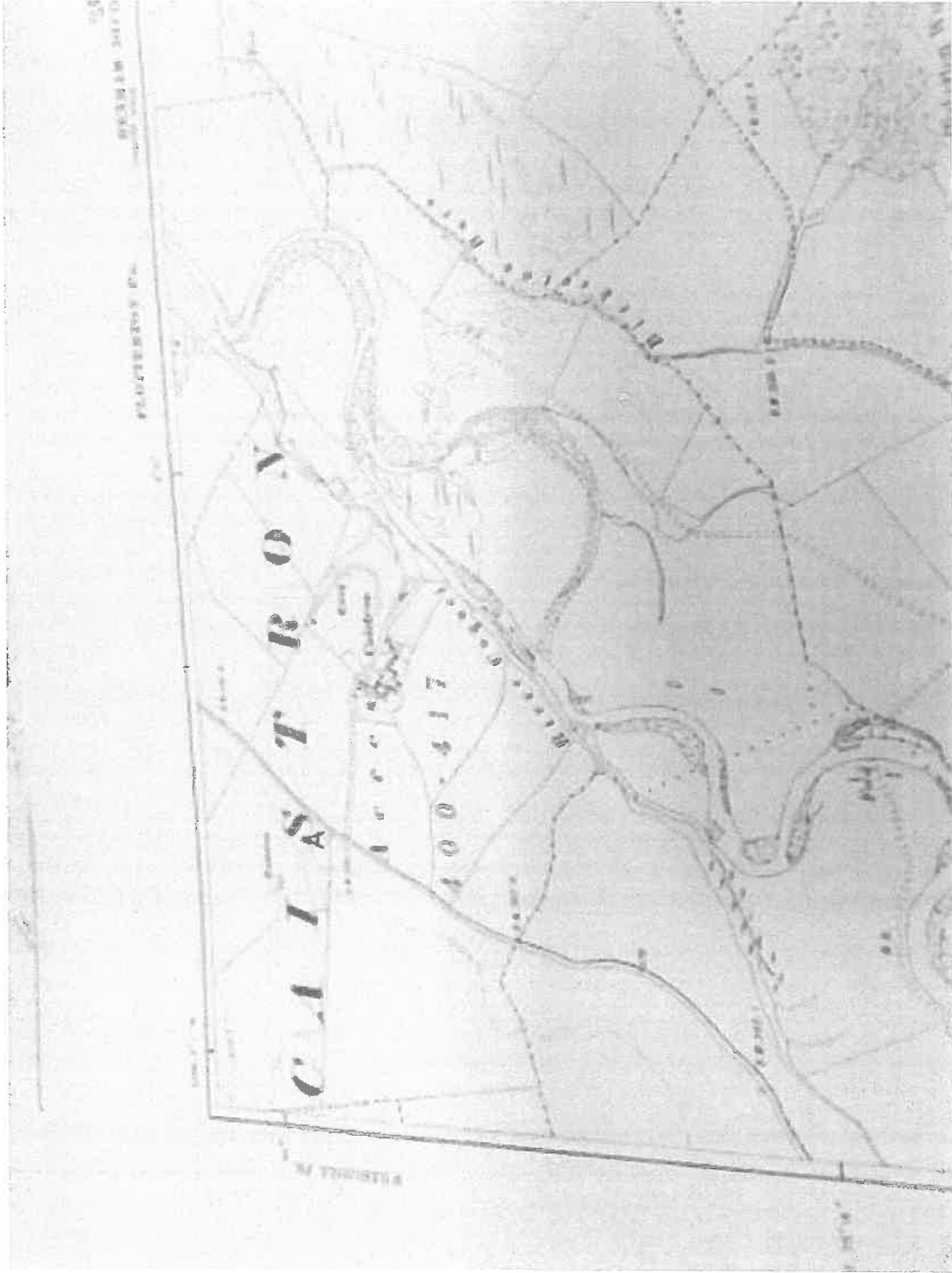

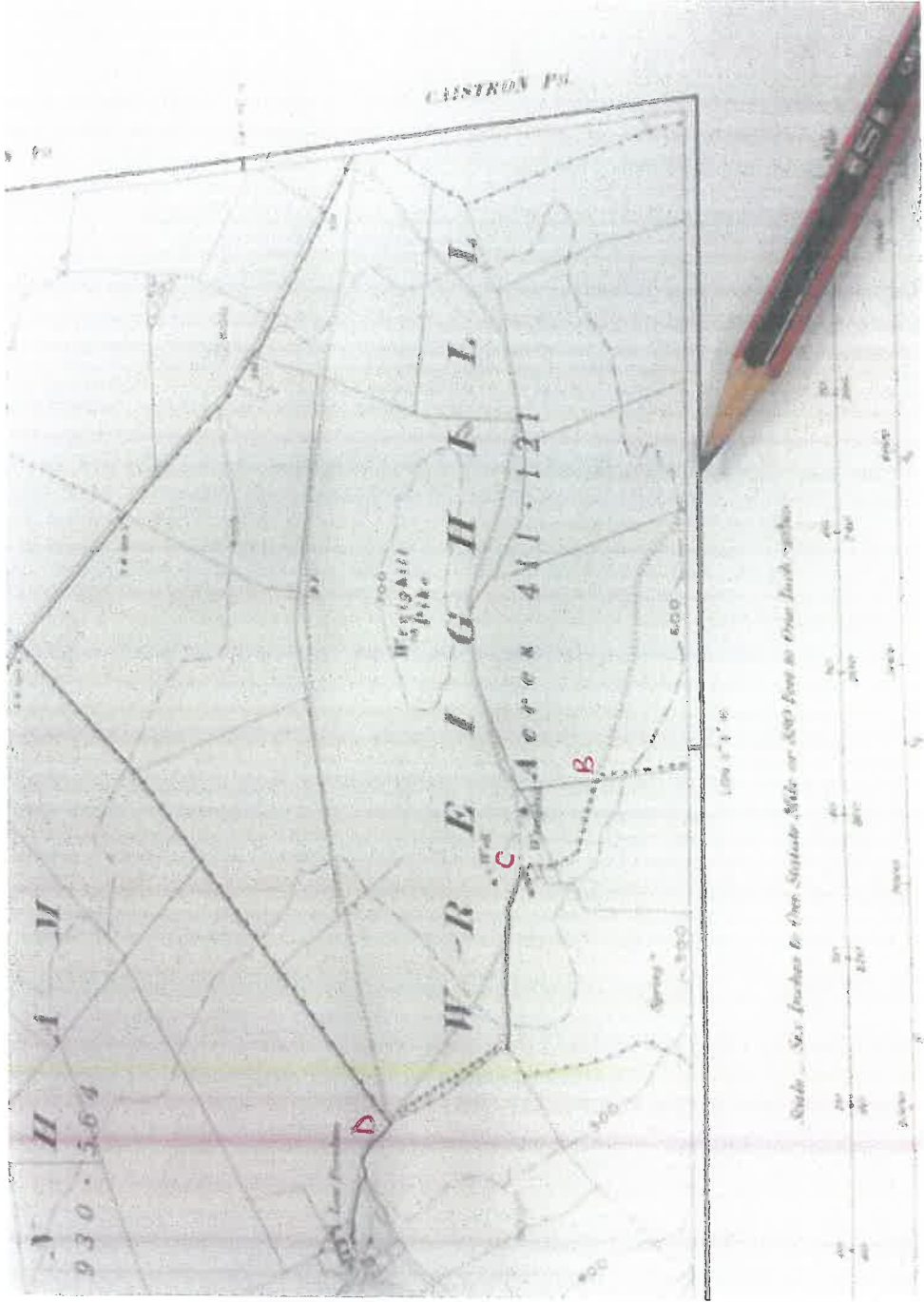

Extract OS 2<sup>nd</sup> Ed XLIII NE

NORTHUMBERLAND SHEET XLIII S.E.  
WINDHILL PH

1899  
A

FRISWOLD PH

GAITTON PH

Heppe

West Hepple

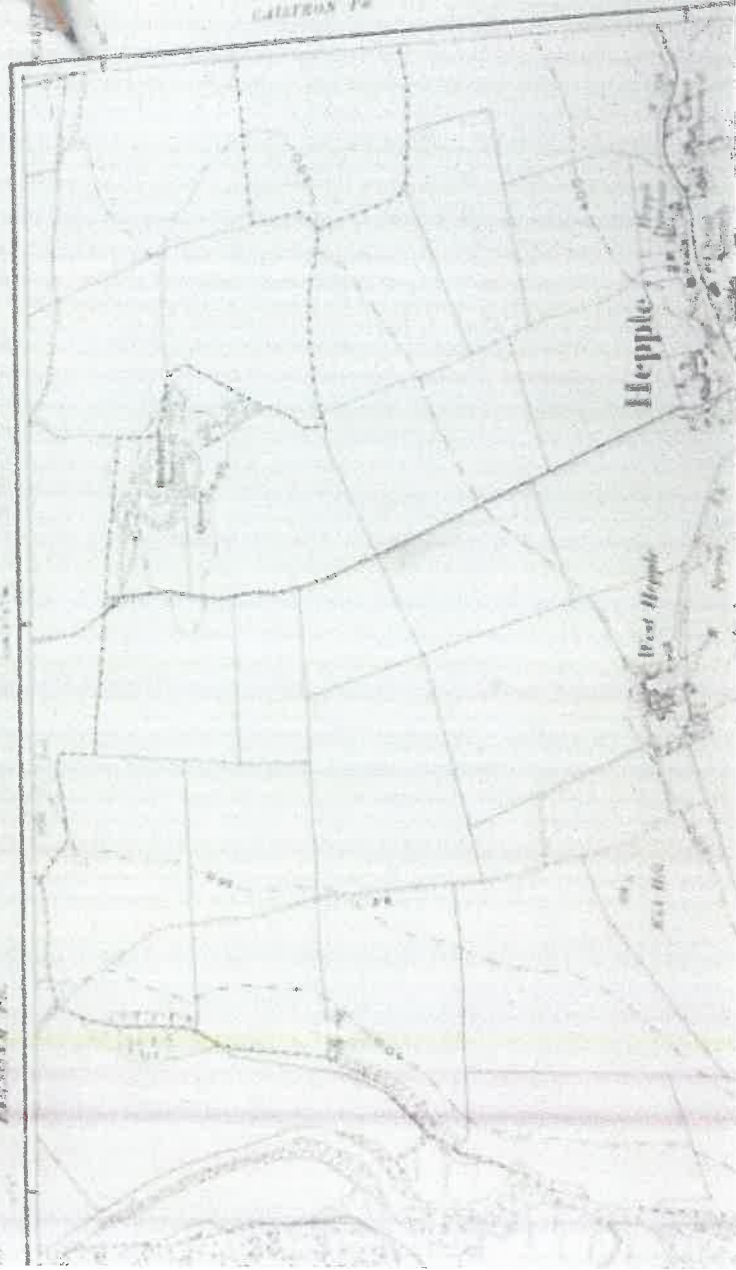



No. of Entries	District	Name of Person or Corporation	Description of Property	Value	Assessment	Tax
7		La. Dixon Brothers	Agri. Lands	Coistron North	245	
8		Wors. of L. & J. Daqlich	Agri. Land	Coistron South 43	40	
9		D. W. Murrant	Buildings	Coistron North		
10		L. C. Bant	Like Rent Charge	Coistron North		
11		Rev. G. E. B. Inc. Ord.	Rectory of Rathburn	Coistron North		
12				Coistron North		
13				Coistron North		
14				Coistron North		



Deductions for

Examinations of Inland Revenue, as amended on Appeal (if any).

Original Full Site Value.	Deductions for								Original Total Value	
	For Year Rent, Rent of Acre, Rent, and Rent of Acre.	Other personal Rent or property	Rate or Title Rent Charge.	Income tax charge on profits of business or other income.	Income tax charge on profits of business or other income.	If Capital Cost of Improvement.	Public Rights of Way or Easement.	Wages of Common.		Reservoirs.
19	20	21	22	23	24	25	26	27	28	29
£	£	£	£	£	£	£	£	£	£	£
19	20	21	22	23	24	25	26	27	28	29
£	£	£	£	£	£	£	£	£	£	£
2500										2400

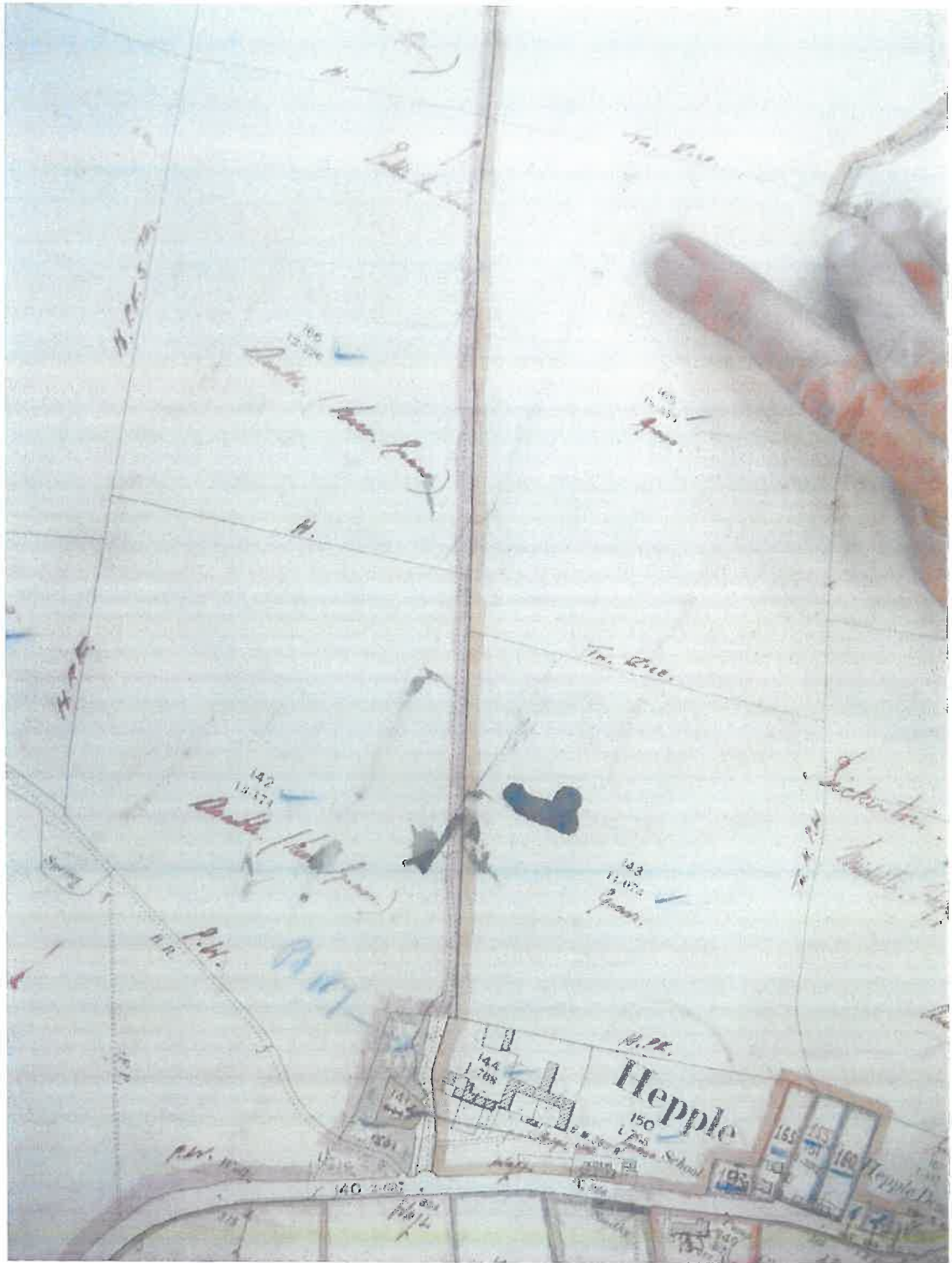

**U4057 from Hepple also marked as 'Public Bye Road'**

ARMSTRONG'S COUNTY MAP  
1769

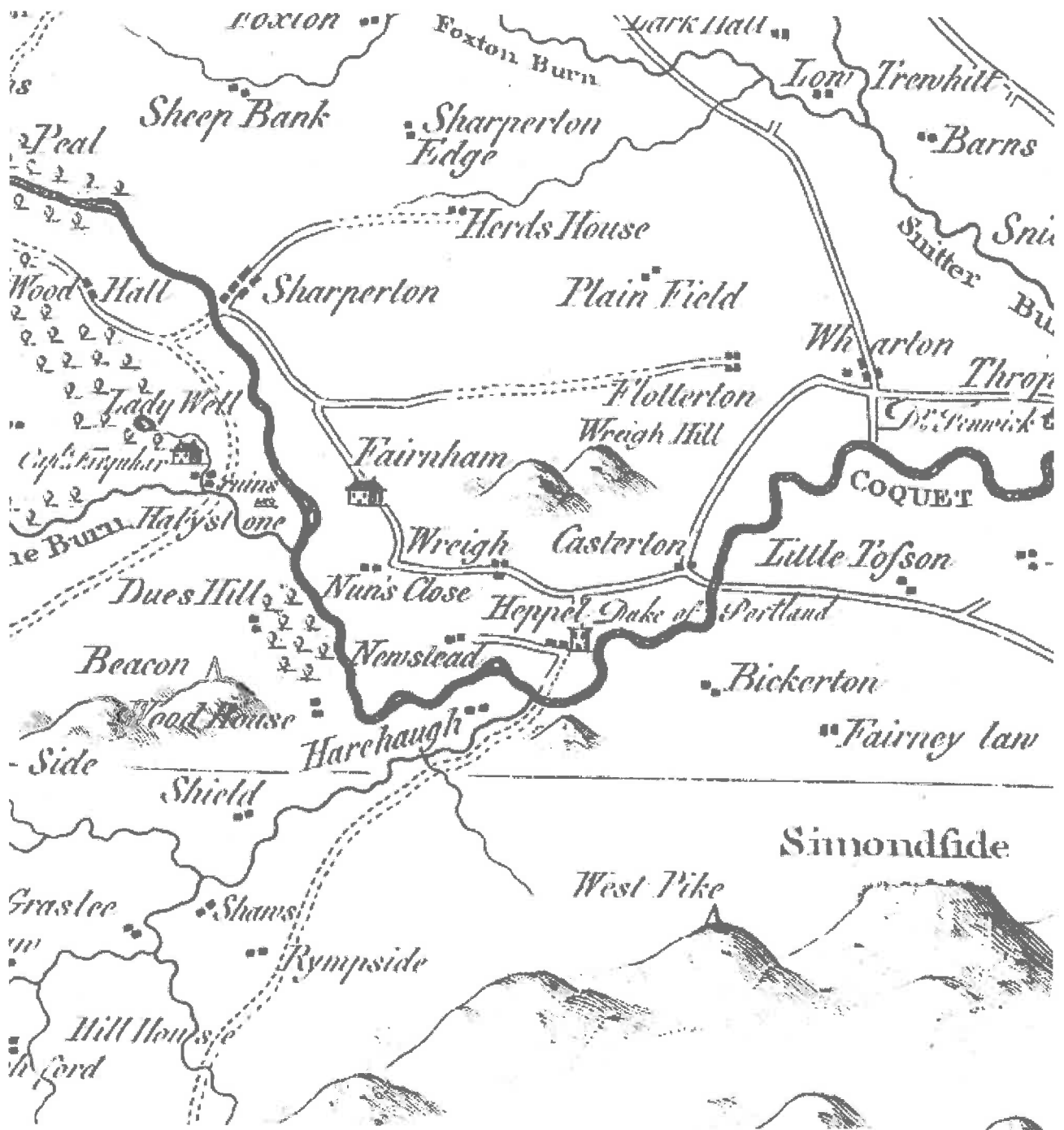

FRYER'S COUNTY MAP  
1820

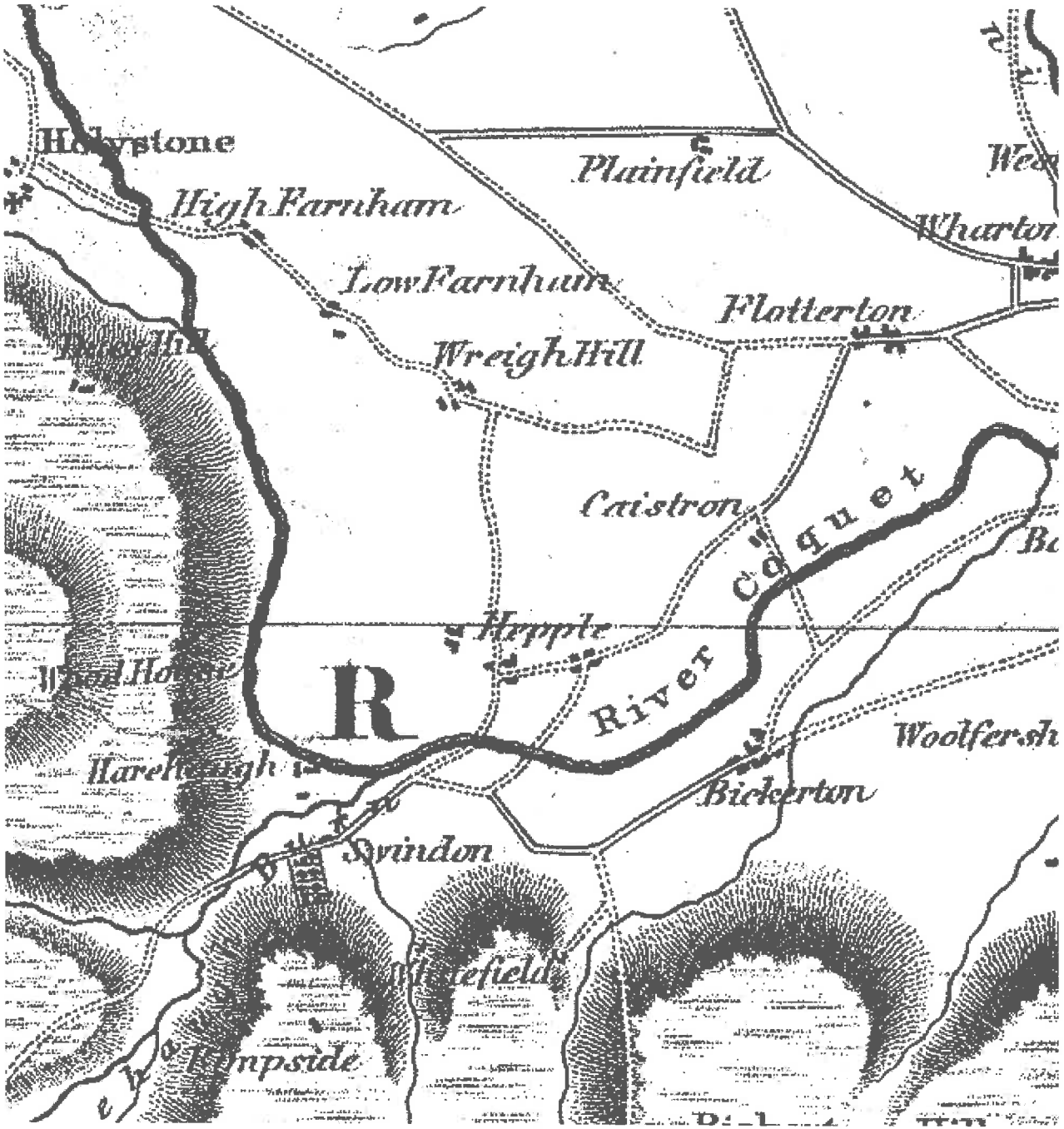

GREENWOOD'S COUNTY MAP  
1828

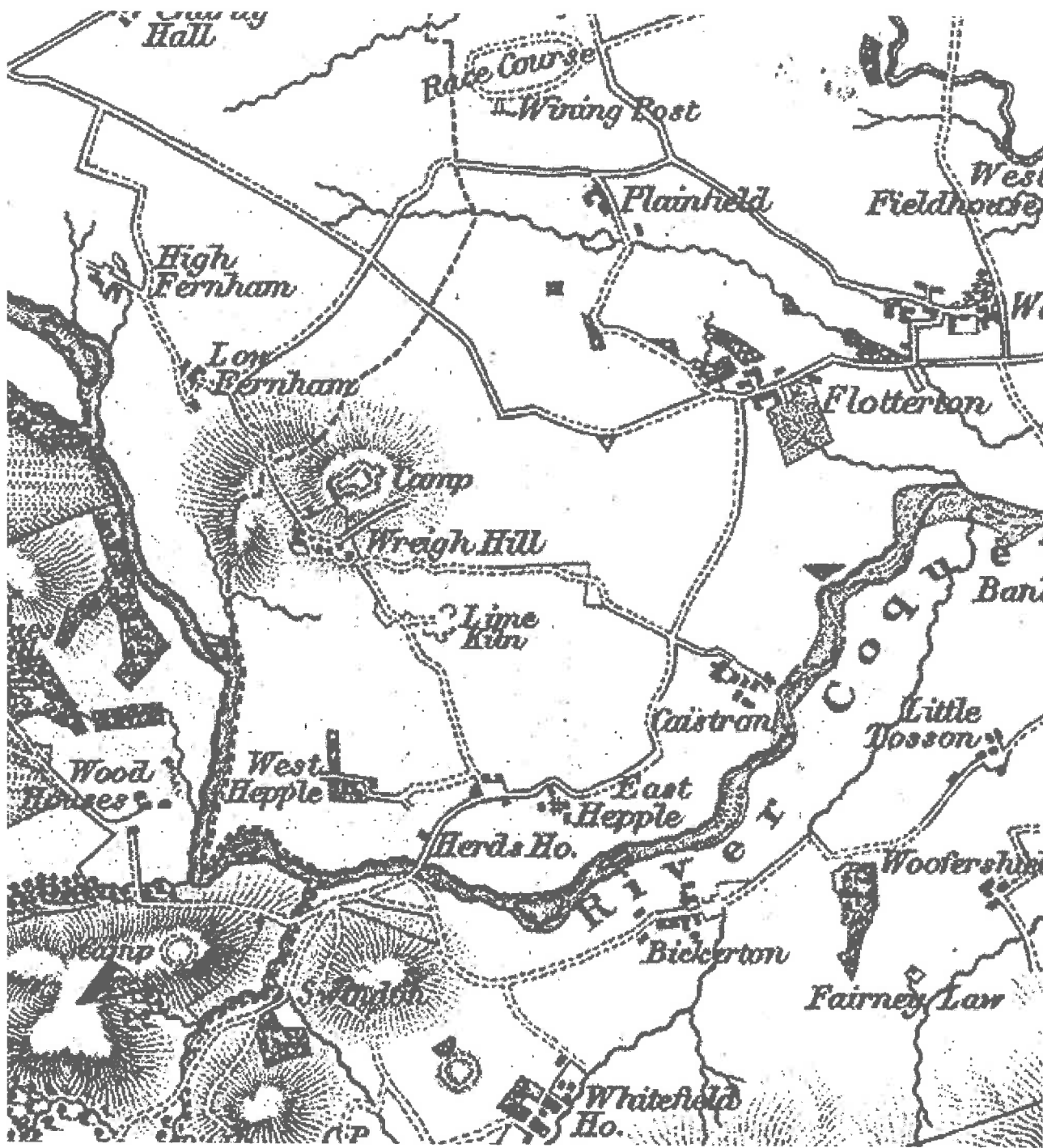

CARY'S COUNTY MAP  
1820-32

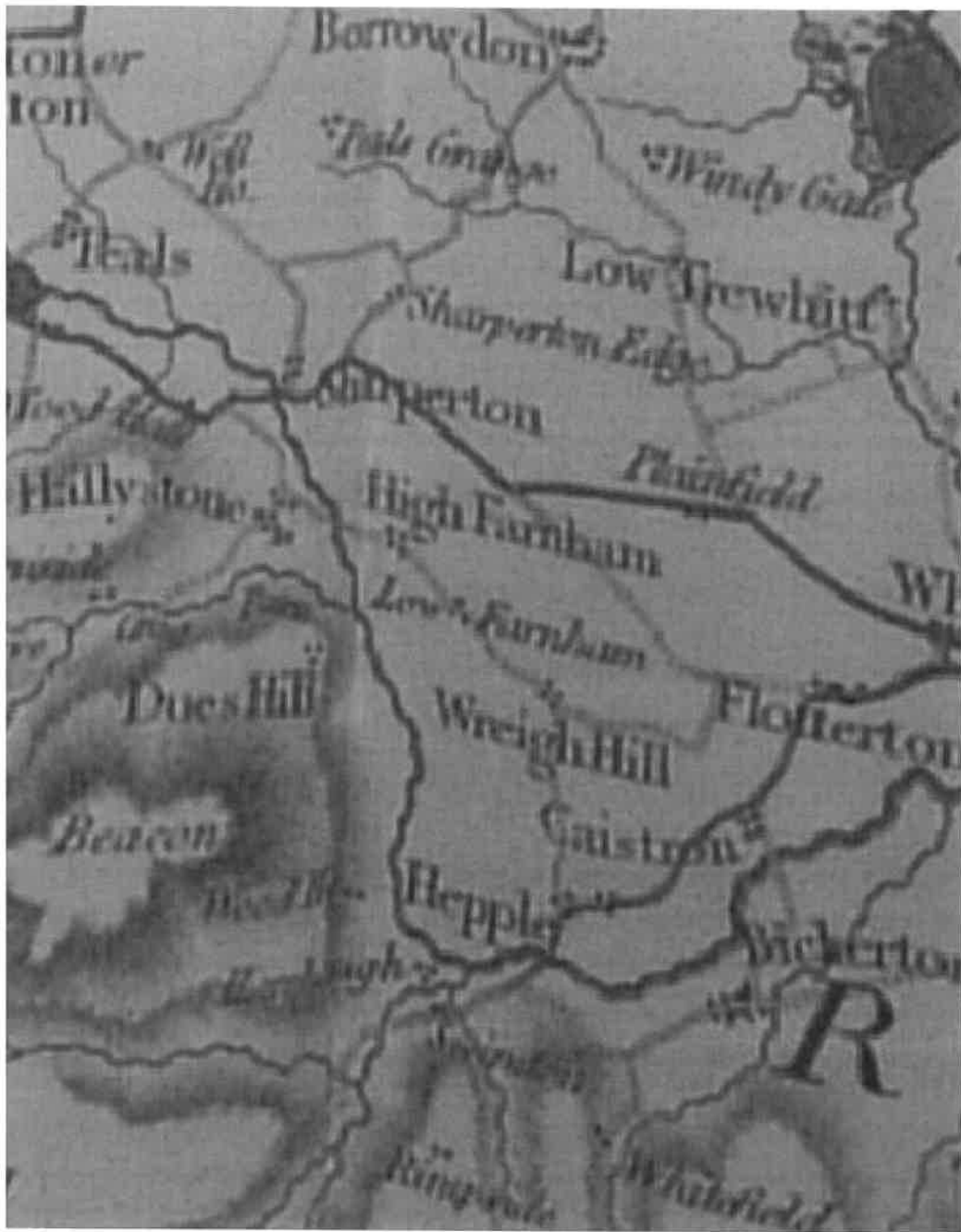

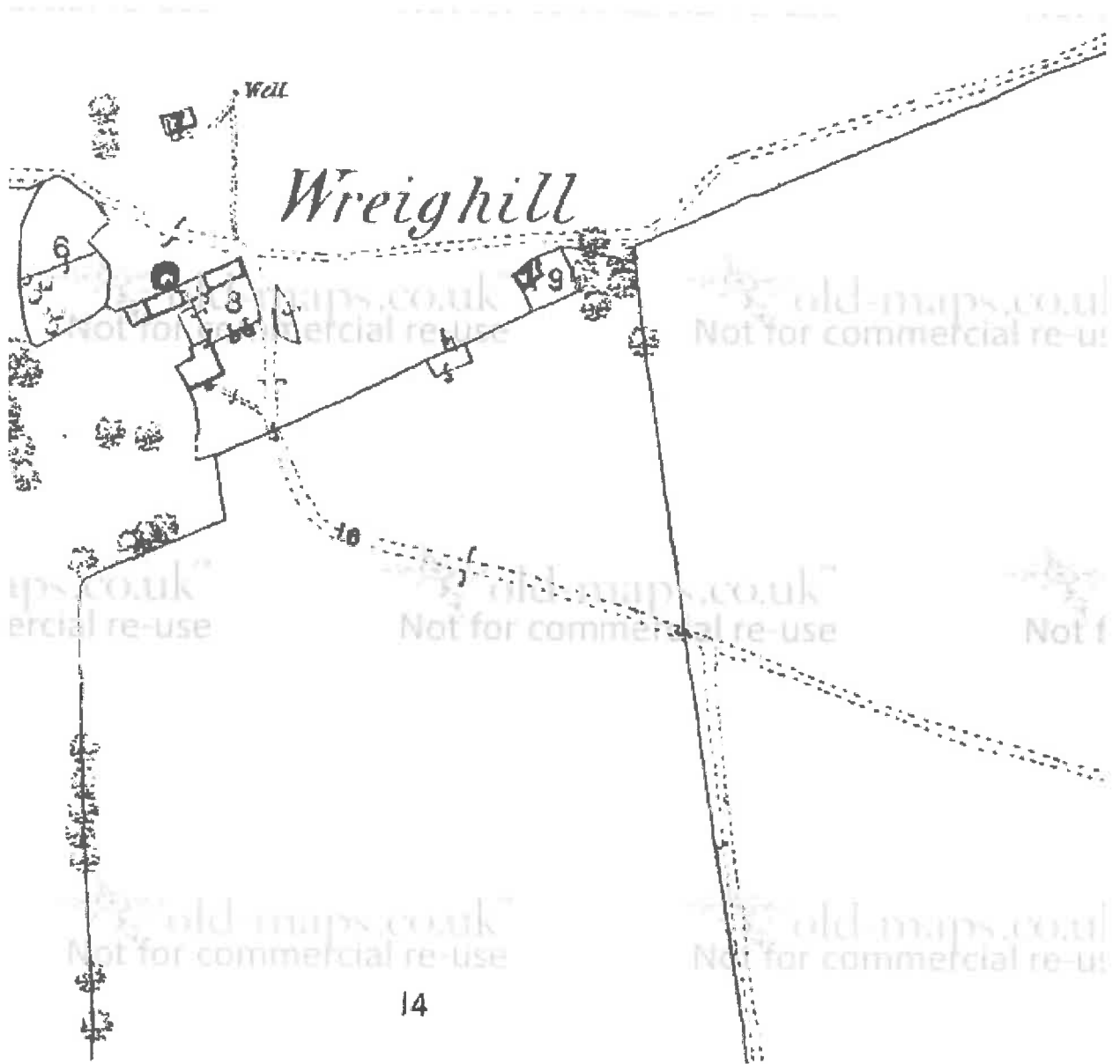





25-87H

3  
23-204

old-maps.co.uk  
Not for commercial re-use

old-maps.co.uk  
Not for commercial re-use

old-maps.co.uk  
Not for commercial re-use

old-maps.co.uk  
Not for commercial re-use

© T  
Not for commercial re-use

old-maps.co.uk  
Not for commercial re-use

old-maps.co.uk  
Not for commercial re-use

*C*

*A*

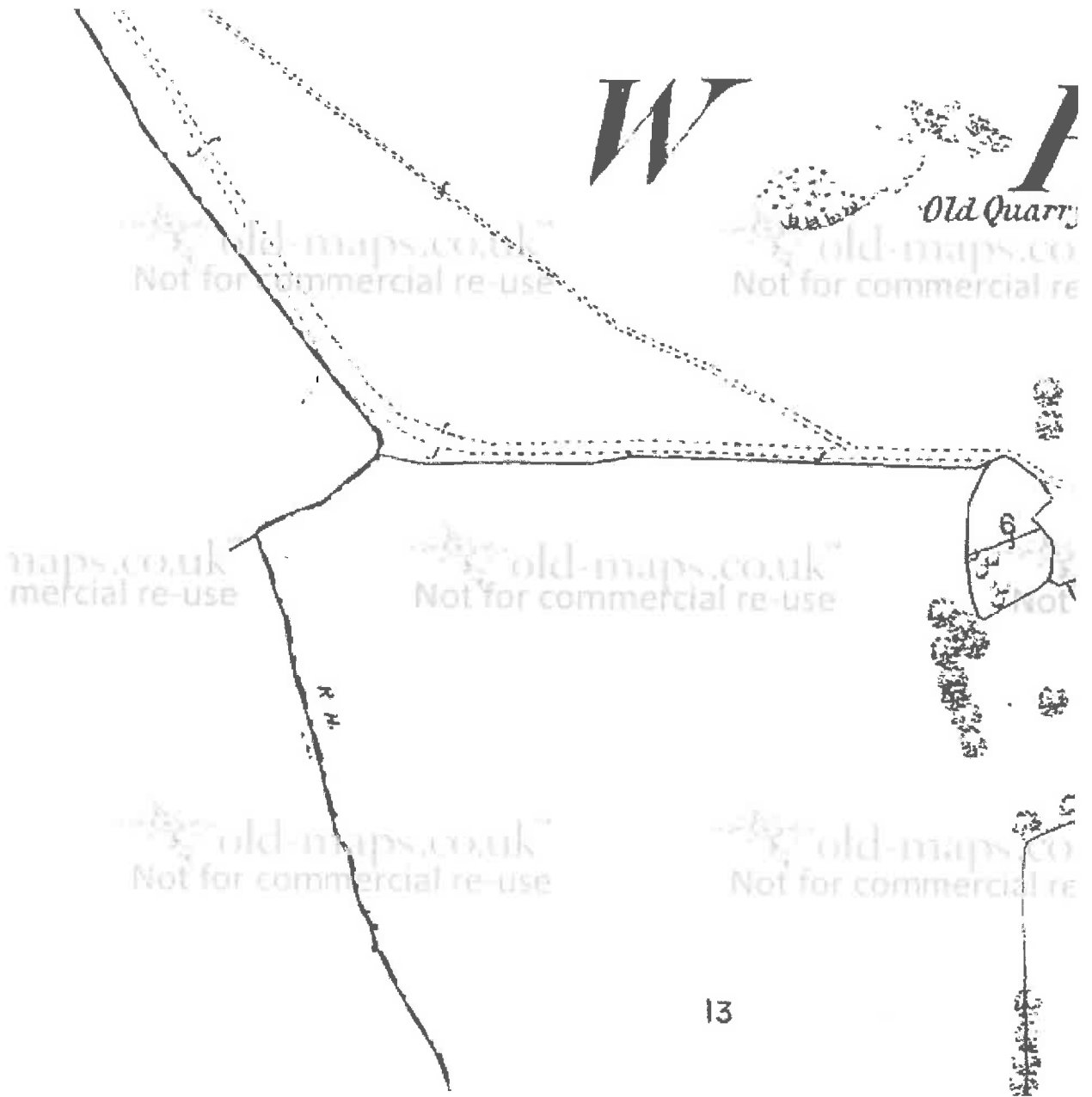

No. on Plan.	Area in Acres.	Remarks.	No. on Plan.	Area in Acres.	Remarks.
<b>TOWNSHIP OF DEBDON</b> (Detached).			<b>RECAPITULATION.</b>		
1	.216	House, garden, &c. (Whitfield House).	411.056	Land.	
2	5.540	Pasture, &c.	.740	Public road.	
3	38.097	Rough pasture.	411.796	Total area of the Township Wreighill.	
	38.853	Area of the Township of Debbon (Detached).			
<b>RECAPITULATION FOR THE TOWNSHIP.</b>			<b>TOWNSHIP OF SNITTER</b>		
	287.084	Land.	1	20.085	Rough pasture, &c.
	.882	Public road.	2	14.600	Pasture.
	287.966	Total area of the Township of Debbon.	3	27.382	Pasture, &c.
			4	24.786	Pasture, &c.
			5	11.509	Pasture.
			6	.883	Houses, yards, garden, &c. (Silverside).
			7	5.597	Pasture.
			8	9.940	Pasture, &c.
			9	10.298	Pasture, &c.
			10	.544	Wood, &c.
			11	14.991	Pasture, &c.
			12	31.368	Pasture.
			13	7.008	Public road.
			14	12.284	Arable.
			15	13.947	Arable.
			16	10.846	Pasture.
			17	21.027	Pasture.
			18	20.710	Pasture, &c.
			18a	.181	Township road.
			19	.860	Houses, yards, garden, &c. (Snitter Barns).
			20	.152	Houses and yards.
			21	.086	Garden, &c.
			22	1.843	Township road.
			23	33.306	Arable.
			24	16.717	Arable.
			25	10.089	Pasture.
			26	14.278	Arable.
			27	16.400	Arable.
			28	15.919	Arable, &c.
			29	31.975	Pasture, &c.
			30	19.110	Arable.
			31	20.579	Arable.
			32	.566	Pasture.
			33	47.469	Pasture, &c.
				487.280	Carried forward.
<b>TOWNSHIP OF WREIGHILL.</b>					
1	17.289	Pasture.			
2	.740	Public road.			
3	35.969	Pasture.			
4	22.482	Pasture.			
5	21.192	Pasture.			
6	.299	Gardens.			
7	.022	House, &c.			
8	.201	Houses, yards, &c.			
9	.072	Houses and garden.			
10	90.688	Pasture, &c.			
11	12.670	Pasture, &c.			
12	22.214	Pasture, &c.			
13	18.718	Pasture, &c.			
14	17.007	Pasture, &c.			
15	40.886	Pasture, &c.			
16	1.104	Pasture.			
17	47.135	Pasture, &c.			
18	85.155	Arable.			
19	28.028	Pasture, &c.			
	411.796				

34  
35  
36  
37  
38  
39  
40  
41  
42  
43  
44  
45  
46  
47  
48  
49  
50  
51  
52  
53  
54  
55  
56  
57  
58  
59  
60  
61  
62  
63  
64  
65  
66  
67  
68  
69  
70  
71  
72  
73  
74  
75  
76

Remarks.	No. on Plan.	Area in Acres.	Remarks.	No. on Plan.	Area in Acres.	Remarks.
<b>TOWNSHIP OF CAISTRON.</b>			<b>TOWNSHIP OF HEPFLE.</b>			
1	13.856	Arable.	2	.141	River Coquet.	
2	23.654	Arable.	3	.168	Pasture.	
3	23.204	Arable, &c.	4	.498	Wood.	
4	23.878	Arable, &c.	5	1.562	Wood.	
5	35.189	Arable.	6	2.749	Pasture.	
6	1.364	Public road.	7	1.743	Pasture, &c.	
7	14.692	Arable.	8	.218	Houses, gardens, &c.	
8	12.066	Arable.	8a	1.498	Stream (Grassless Burn).	
9	20.725	Pasture.	9	2.928	Pasture.	
10	29.915	Pasture.	10	.082	Pasture.	
11	8.281	Pasture.	11	.496	Garden.	
12	.822	Pasture.	12	.458	Garden.	
13	.550	Public road.	13	.617	Garden.	
14	.599	Yards, &c.	14	.617	Arable.	
15	2.919	Houses, yards, gardens, &c. (Caistron).	15	1.047	Pasture, &c.	
16	11.961	Arable.	16	5.774	Wood.	
16a	.271	Garden.	17	2.116	Public road.	
17	8.037	Pasture.	18	23.408	Wood, &c.	
18	9.567	Arable.	19	.172	Wood.	
19	7.393	Arable.	20	4.845	Pasture, &c.	
20	10.821	Arable.	21	.163	Wood.	
21	11.704	Pasture.	22	.447	Garden.	
22	18.348	Pasture, &c.	23	.707	Wood.	
23	.903	Stream.	23a	.002	House (part of).	
24	10.223	Pasture, &c.	24	.080	Pasture.	
25	21.280	River Coquet.	25	.566	Rough pasture.	
26	31.151	Pasture, &c.	26	22.573	Wood.	
27	32.908	Pasture, &c.	27	1.864	Wood, &c.	
28	12.942	Arable.	28	.557	Pasture.	
	400.635		29	1.694	Wood.	
			30	.559	Garden, &c.	
			31	.766	Wood.	
			32	15.924	Arable.	
			33	2.390	Wood.	
			34	4.269	Wood.	
			35	118.324	Rough pasture.	
			36	9.559	Wood, &c.	
			37	.391	Wood.	
			38	4.721	Rough pasture, &c.	
			39	3.820	Wood.	
			40	4.626	Wood, &c.	
			41	1.224	Wood, &c.	
			42	.426	Wood.	
			43	.531	Wood.	
			44	.416	Wood.	
			45	.426	Wood.	
				247.694	Carried forward.	
<b>RECAPITULATION.</b>						
	376.518	Land.				
	1.934	Public roads.				
	22.183	Water.				
	400.635	Total area of the Township of Caistron.				

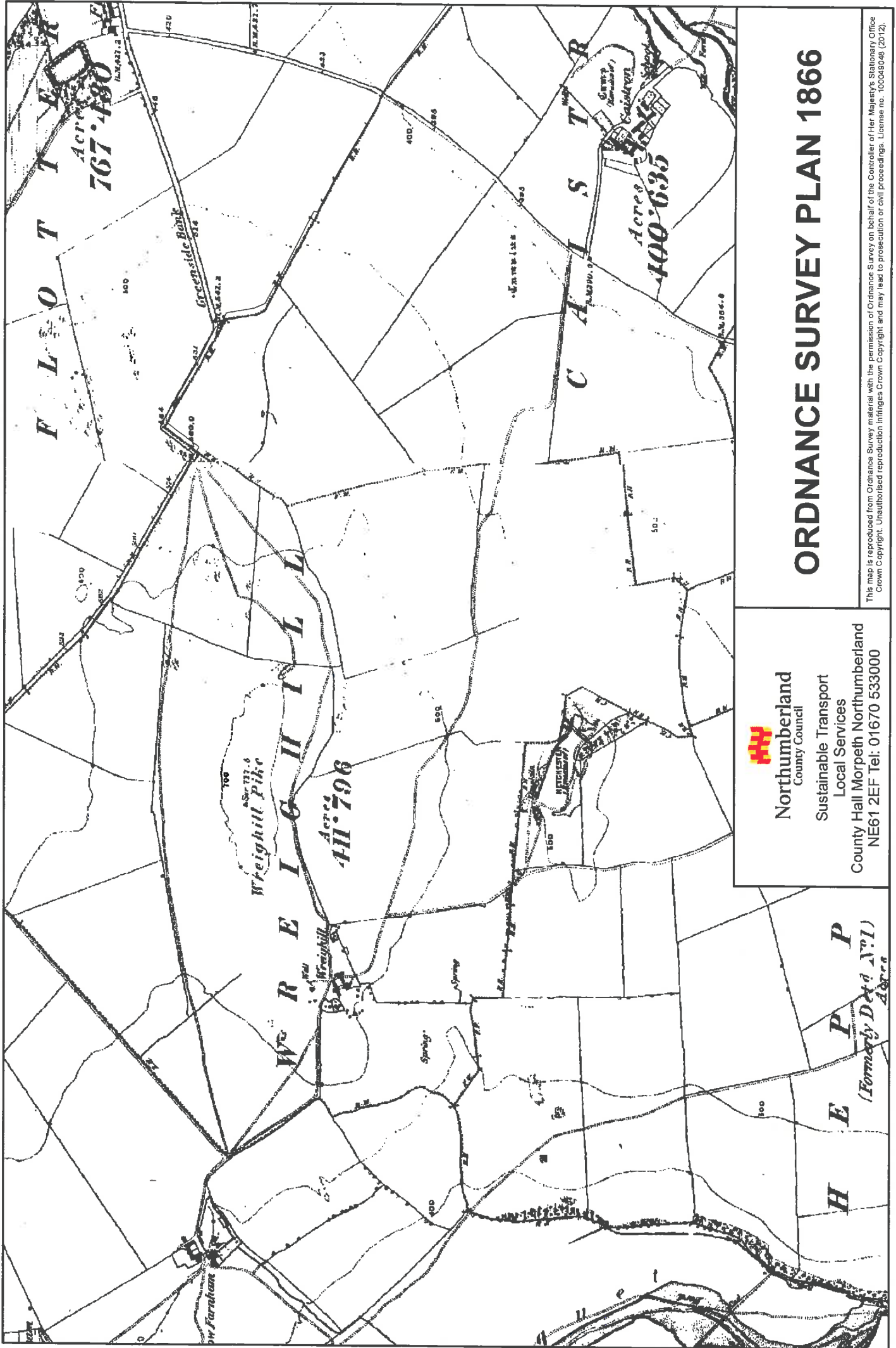

# ORDNANCE SURVEY PLAN 1866



**Northumberland**  
County Council

Sustainable Transport  
Local Services

County Hall Morpeth Northumberland  
NE61 2EF Tel: 01670 533000

This map is reproduced from Ordnance Survey material with the permission of Ordnance Survey on behalf of the Controller of Her Majesty's Stationery Office. Crown Copyright. Unauthorised reproduction infringes Crown Copyright and may lead to prosecution or civil proceedings. License no. 100049046 (2012).

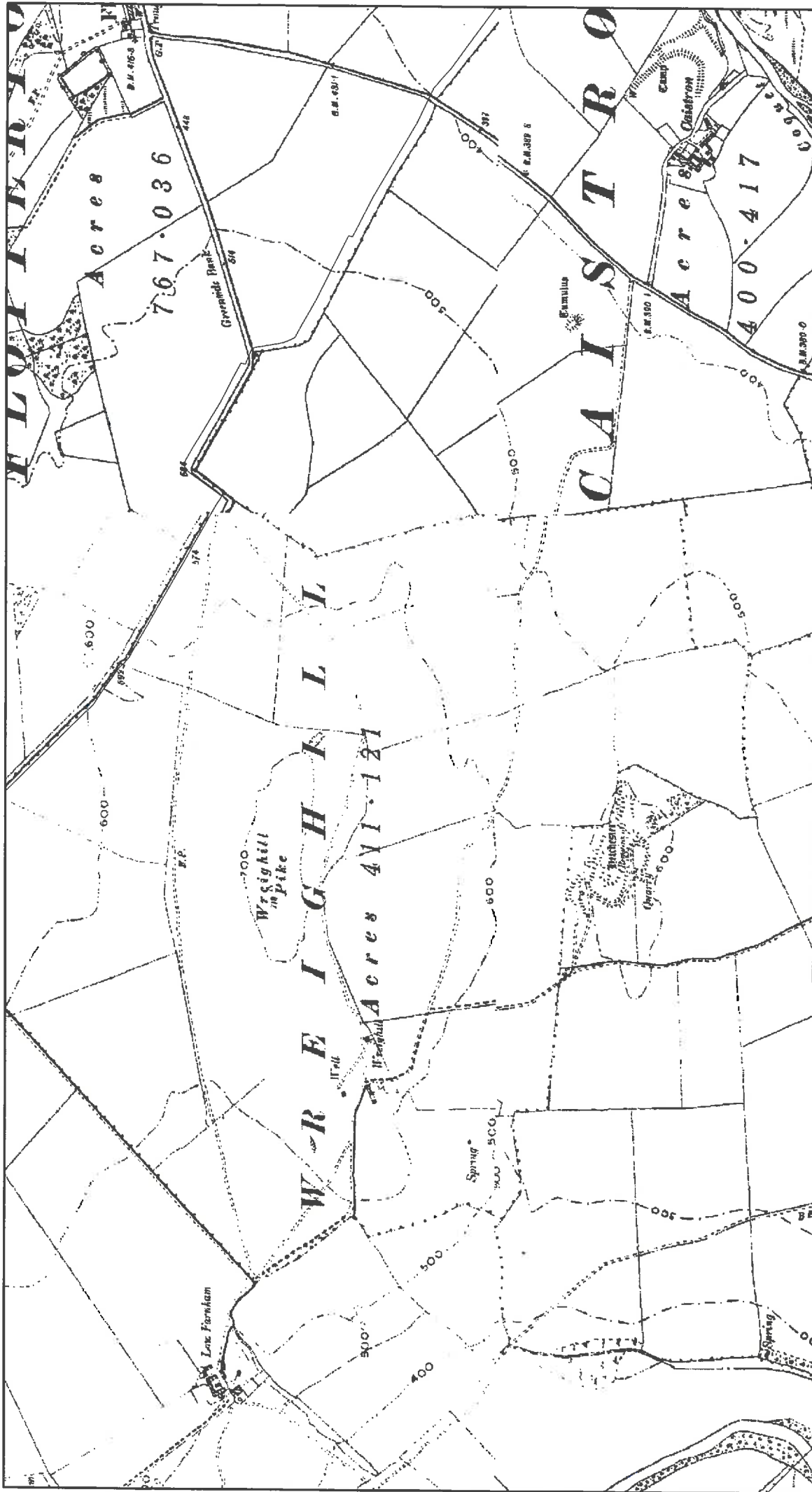

**Northumberland**  
 County Council  
 Sustainable Transport  
 Local Services  
 County Hall Morpeth Northumberland  
 NE61 2EF Tel: 01670 533000

**ORDNANCE SURVEY PLAN 1899**  
This map is reproduced from Ordnance Survey material with the permission of Ordnance Survey on behalf of the Controller of Her Majesty's Stationary Office. Crown Copyright. Unauthorised reproduction infringes Crown Copyright and may lead to prosecution or civil proceedings. License no. 100049048 (2012).

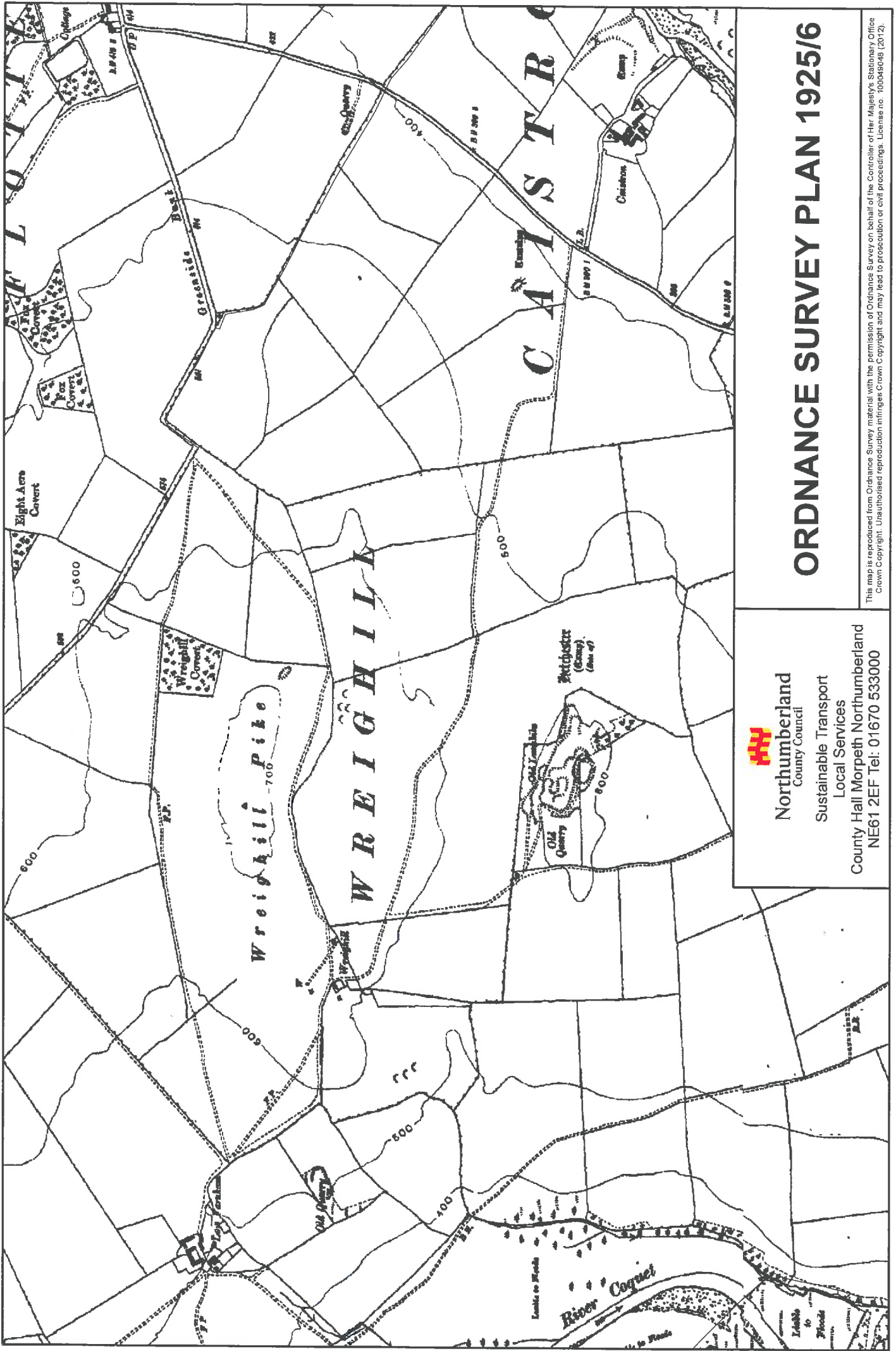

# ORDNANCE SURVEY PLAN 1925/6



Northumberland  
County Council

Sustainable Transport  
Local Services

County Hall Morpeth Northumberland  
NE61 2EF Tel: 01670 533000

This map is reproduced from Ordnance Survey material with the permission of Ordnance Survey on behalf of the Controller of Her Majesty's Stationary Office. Crown Copyright. Unauthorised reproduction infringes Crown Copyright and may lead to prosecution or civil proceedings. License no. 100048048 (2012).

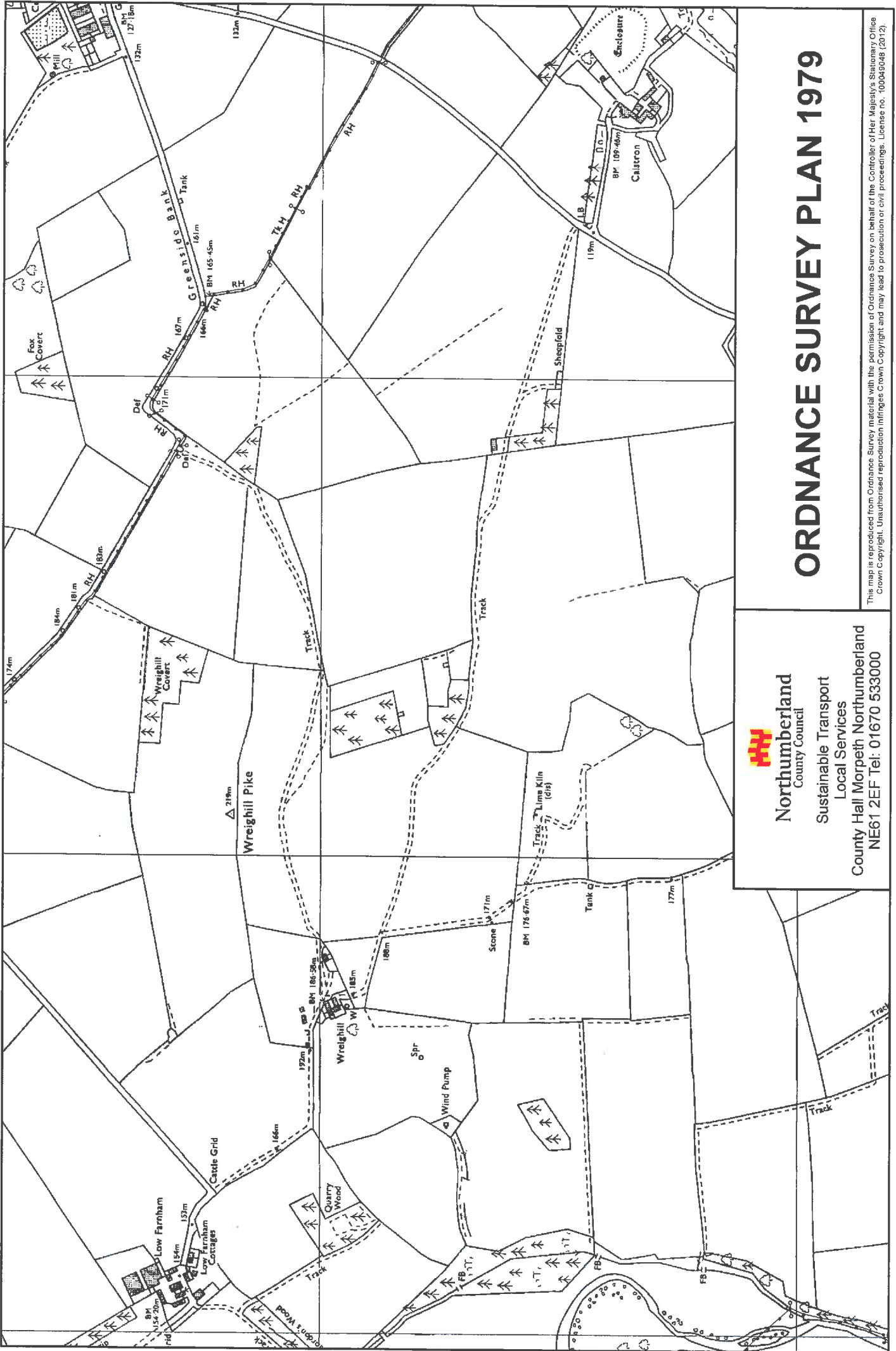

# ORDNANCE SURVEY PLAN 1979



**Northumberland**  
County Council

Sustainable Transport  
Local Services

County Hall Morpeth Northumberland  
NE61 2EF Tel: 01670 533000

This map is reproduced from Ordnance Survey material with the permission of Ordnance Survey on behalf of the Controller of Her Majesty's Stationary Office. Crown Copyright. Unauthorised reproduction infringes Crown Copyright and may lead to prosecution or civil proceedings. License no. 100049048 (2012).



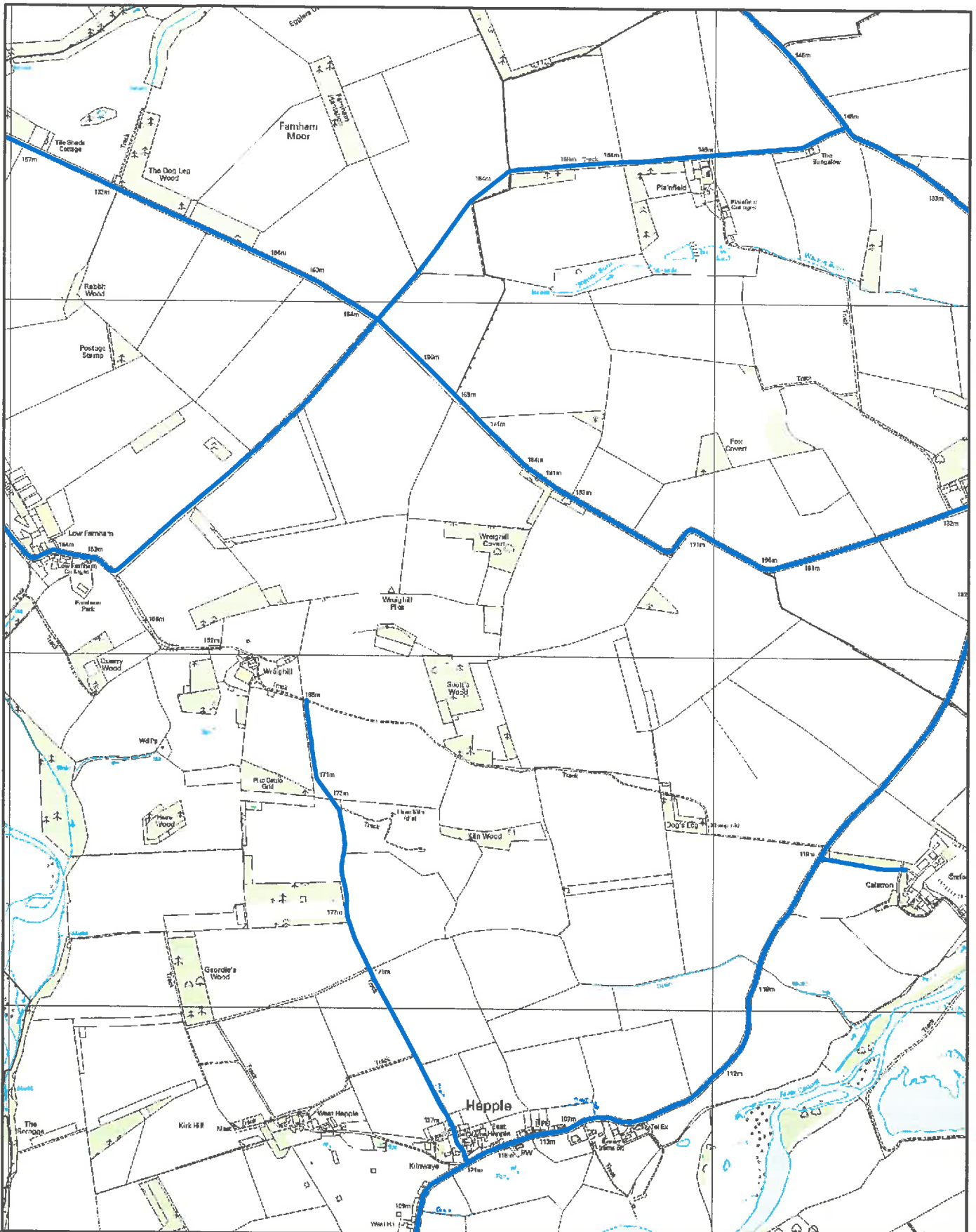

**NORTHUMBERLAND**  
Northumberland County Council

**Network Management  
Information System**

Highways Act 1980 Section 36(6)  
County of Northumberland  
List of Streets which are highways  
maintainable at the public expense  
as at 02-May-2006

This map is reproduced from Ordnance Survey material with the permission of Ordnance Survey on behalf of the Controller of Her Majesty's Stationary Office Crown Copyright. Unauthorised reproduction infringes Crown Copyright and may lead to prosecution or civil proceedings. License no. 100049048 (2015).

Dm:

Date:

Scale:

AB

May 2015

1:10,000